





**Material:** Copper tube (Cu) 99% up **Surface:** Tin plated **Range size (mm<sup>3</sup>):** 1.5-1000

No.	Items	Dimension (mm)							Thickness (mm)	Weight (g)
		d2	d1	D	B	E	F	L		
18	SC500-12	13	31.8	39	56	48	48	124	3.6	428.5
	SC500-14	15	31.8	39	56	48	124	3.6	425.7	
	SC500-16	17	31.8	39	56	48	124	3.6	422.5	
	SC500-18	19	31.8	39	56	48	124	3.6	418.9	
	SC500-20	21	31.8	39	56	48	124	3.6	414.9	
19	SC630-12	13	36	44	63.5	52	51	130	4	565.7
	SC630-14	15	36	44	63.5	52	51	130	4	562.6
	SC630-16	17	36	44	63.5	52	51	130	4	559
	SC630-18	19	36	44	63.5	52	51	130	4	555
	SC630-20	21	36	44	63.5	52	51	130	4	550.6
20	SC800-12	15	41.6	51.2	74	54	56	140	4.8	847.1
	SC800-14	17	41.6	51.2	74	54	56	140	4.8	842.8
	SC800-16	19	41.6	51.2	74	54	56	140	4.8	838
	SC800-18	21	41.6	51.2	74	54	56	140	4.8	832.8
	SC1000-14	15	46.6	56.6	81.5	60	56	146	5	1,425.30
21	SC1000-16	17	46.6	56.6	81.5	60	56	146	5	1,420.80
	SC1000-18	19	46.6	56.6	81.5	60	56	146	5	1,415.80
	SC1000-20	21	46.6	56.6	81.5	60	56	146	5	1,410.30
	SC1000-22	23	46.6	56.6	81.5	60	56	146	5	1,410.30

CRIMPING TOOLS

Item size (mm2)	1.5 - 10	6 - 16	10 - 25	10 - 35	> 35
Tools	 LS-8	 LS-16	 LS-22	 LS-38	 YQK-300

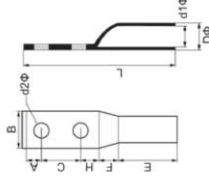

**Material:** Copper tube (Cu) 99% up **Surface:** Tin plated **Range size (mm<sup>3</sup>):** 10-1000

Items	d2	d1	D	Dimension (mm)							Thickness (mm)	Weight (g)
				A	B	C	E	F	H	L		
TTL10-6	6.2	4.5	6.2	7.5	12	44.4	21.5	7.4	9.5	90.3	0.85	10.45
TTL10-8	8.2	4.5	6.2	7.5	12	44.4	21.5	7.4	9.5	90.3	0.85	9.77
TTL10-10	10.2	4.5	6.2	7.5	14	44.4	21.5	7.4	9.5	90.3	0.85	8.95
TTL16-6	6.2	5.4	7.1	8	12	44.4	25	7.4	10	94.8	0.85	13
TTL16-8	8.2	5.4	7.1	8	12	44.4	25	7.4	10	94.8	0.85	12.32
TTL16-10	10.2	5.4	7.1	8	14	44.4	25	7.4	10	94.8	0.85	11.5
TTL16-12	12.2	5.4	7.1	8	16.5	44.4	25	7.4	10	94.8	0.85	10.3
TTL25-6	6.2	6.8	8.8	8.5	15	44.4	28.5	7.4	10.5	99.3	1	20.4
TTL25-8	8.2	6.8	8.8	8.5	15	44.4	28.5	7.4	10.5	99.3	1	19.6
TTL25-10	10.2	6.8	8.8	8.5	15	44.4	28.5	7.4	10.5	99.3	1	18.6
TTL25-12	12.2	6.8	8.8	8.5	16.5	44.4	28.5	7.4	10.5	99.3	1	17.2
TTL35-6	6.5	8.2	10.6	9	17	44.4	32	8	11	104.4	1.2	31.4
TTL35-8	8.5	8.2	10.6	9	17	44.4	32	8	11	104.4	1.2	30.6
TTL35-10	10.5	8.2	10.6	9	17	44.4	32	8	11	104.4	1.2	29.2
TTL35-12	12.5	8.2	10.6	9	17	44.4	32	8	11	104.4	1.2	27.6
TTL50-8	8.5	9.5	12.4	12.7	19	44.4	35	10.9	14.7	117.7	1.45	48.9
TTL50-10	10.5	9.5	12.4	12.7	19	44.4	35	10.9	14.7	117.7	1.45	47.3
TTL50-12	12.5	9.5	12.4	12.7	19	44.4	35	10.9	14.7	117.7	1.45	45.4
TTL50-14	15	9.5	12.4	12.7	21	44.4	35	10.9	14.7	117.7	1.45	42.7
TTL50-16	17	9.5	12.4	12.7	23	44.4	35	10.9	14.7	117.7	1.45	40.3
TTL70-8	8.5	11.2	14.7	13.9	21	44.4	35	10.9	17.9	122.1	1.75	73.1
TTL70-10	10.5	11.2	14.7	13.9	21	44.4	35	10.9	17.9	122.1	1.75	71.3
TTL70-12	12.5	11.2	14.7	13.9	21	44.4	35	10.9	17.9	122.1	1.75	69.1
TTL70-14	15	11.2	14.7	13.9	21	44.4	35	10.9	17.9	122.1	1.75	65.7
TTL70-16	17	11.2	14.7	13.9	24	44.4	35	10.9	17.9	122.1	1.75	62.7
TTL95-8	8.5	13.5	17.4	13.9	25.5	44.4	38	15.8	17.9	130	1.95	104.5
TTL95-10	10.5	13.5	17.4	13.9	25.5	44.4	38	15.8	17.9	130	1.95	102.5
TTL95-12	13	13.5	17.4	13.9	25.5	44.4	38	15.8	17.9	130	1.95	99.3

**Material:** Copper tube (Cu) 99% up **Surface:** Tin plated **Range size (mm<sup>3</sup>):** 10-1000

Items	Dimension (mm)											Thickness (mm)	Weight (g)
	d2	d1	D	A	B	C	E	F	H	L	L		
TTL95-14	15	13.5	17.4	13.9	25.5	44.4	38	15.8	17.9	130	1.95	96.3	
TTL95-16	17	13.5	17.4	13.9	25.5	44.4	38	15.8	17.9	130	1.95	92.9	
TTL120-8	8.5	15	19.4	13.9	28	44.4	40	18.8	17.9	135	2.2	136.8	
TTL120-10	10.5	15	19.4	13.9	28	44.4	40	18.8	17.9	135	2.2	134.6	
TTL120-12	13	15	19.4	13.9	28	44.4	40	18.8	17.9	135	2.2	131	
TTL120-14	15	15	19.4	13.9	28	44.4	40	18.8	17.9	135	2.2	127.6	
TTL120-16	17	15	19.4	13.9	28	44.4	40	18.8	17.9	135	2.2	123.8	
TTL150-10	10.5	16.5	21.2	13.9	30.5	44.4	50	19.8	17.9	146	2.35	171.8	
TTL150-12	13	16.5	21.2	13.9	30.5	44.4	50	19.8	17.9	146	2.35	168	
TTL150-14	15	16.5	21.2	13.9	30.5	44.4	50	19.8	17.9	146	2.35	164.2	
TTL150-16	17	16.5	21.2	13.9	30.5	44.4	50	19.8	17.9	146	2.35	160.2	
TTL185-12	13	18.5	23.5	13.9	34	44.4	50	19.8	17.9	146	2.5	200.3	
TTL185-14	15	18.5	23.5	13.9	34	44.4	50	19.8	17.9	146	2.5	196.3	
TTL185-16	17	18.5	23.5	13.9	34	44.4	50	19.8	17.9	146	2.5	192.1	
TTL185-18	19	18.5	23.5	13.9	34	44.4	50	19.8	17.9	146	2.5	187.1	
TTL185-20	21	18.5	23.5	13.9	34	44.4	50	19.8	17.9	146	2.5	181.5	
TTL240-12	13	21	26.5	13.9	38.5	44.4	56	24.8	17.9	157	2.75	270.7	
TTL240-14	15	21	26.5	13.9	38.5	44.4	56	24.8	17.9	157	2.75	266.5	
TTL240-16	17	21	26.5	13.9	38.5	44.4	56	24.8	17.9	157	2.75	261.5	
TTL240-18	19	21	26.5	13.9	38.5	44.4	56	24.8	17.9	157	2.75	256.1	
TTL240-20	21	21	26.5	13.9	38.5	44.4	56	24.8	17.9	157	2.75	250.1	
TTL300-12	13	23.5	30	13.9	43.5	44.4	67	26.8	17.9	170	3.25	393.4	
TTL300-14	15	23.5	30	13.9	43.5	44.4	67	26.8	17.9	170	3.25	388.4	
TTL300-16	17	23.5	30	13.9	43.5	44.4	67	26.8	17.9	170	3.25	382.8	
TTL300-18	19	23.5	30	13.9	43.5	44.4	67	26.8	17.9	170	3.25	376.2	
TTL300-20	21	23.5	30	13.9	43.5	44.4	67	26.8	17.9	170	3.25	369	
TTL400-12	13	28.5	36.5	13.9	53	44.4	67	26.8	17.9	170	4	592.4	
TTL400-14	15	28.5	36.5	13.9	53	44.4	67	26.8	17.9	170	4	586.2	
TTL400-16	17	28.5	36.5	13.9	53	44.4	67	26.8	17.9	170	4	579	
TTL400-18	19	28.5	36.5	13.9	53	44.4	67	26.8	17.9	170	4	571	
TTL400-20	21	28.5	36.5	13.9	53	44.4	67	26.8	17.9	170	4	562.2	
TTL400-22	23	28.5	36.5	13.9	53	44.4	67	26.8	17.9	170	4	552.6	
TTL500-12	13	30	39	13.9	56	44.4	75	33.8	17.9	185	4.5	773	
TTL500-14	15	30	39	13.9	56	44.4	75	33.8	17.9	185	4.5	766	
TTL500-16	17	30	39	13.9	56	44.4	75	33.8	17.9	185	4.5	758	
TTL500-18	19	30	39	13.9	56	44.4	75	33.8	17.9	185	4.5	749.2	
TTL500-20	21	30	39	13.9	56	44.4	75	33.8	17.9	185	4.5	739.2	
TTL500-22	23	30	39	13.9	56	44.4	75	33.8	17.9	185	4.5	728.2	

**Material:** Copper tube (Cu) 99% up **Surface:** Tin plated **Range size (mm<sup>3</sup>):** 10-1000

Items	Dimension (mm)											Thickness (mm)	Weight (g)
	d2	d1	D	A	B	C	E	F	H	L	L		
TTL630-12	13	34.5	44	16.5	63.5	44.4	80	37.8	20.5	199.2	4.75	1004.70	
TTL630-14	15	34.5	44	16.5	63.5	44.4	80	37.8	20.5	199.2	4.75	997.1	
TTL630-16	17	34.5	44	16.5	63.5	44.4	80	37.8	20.5	199.2	4.75	988.7	
TTL630-18	19	34.5	44	16.5	63.5	44.4	80	37.8	20.5	199.2	4.75	979.3	
TTL630-20	21	34.5	44	16.5	63.5	44.4	80	37.8	20.5	199.2	4.75	968.7	
TTL630-22	23	34.5	44	16.5	63.5	44.4	80	37.8	20.5	199.2	4.75	957.3	
TTL800-14	15	40	51.2	16.5	74	44.4	85	41.8	25.5	213.2	5.6	1,470.30	
TTL800-16	17	40	51.2	16.5	74	44.4	85	41.8	25.5	213.2	5.6	1,460.30	
TTL800-18	19	40	51.2	16.5	74	44.4	85	41.8	25.5	213.2	5.6	1,449.30	
TTL800-20	21	40	51.2	16.5	74	44.4	85	41.8	25.5	213.2	5.6	1,436.90	
TTL1000-14	15	44	56.6	16.5	81.5	44.4	90	45	30.5	226.4	6.3	1,944.20	
TTL1000-16	17	44	56.6	16.5	81.5	44.4	90	45	30.5	226.4	6.3	1,933.20	
TTL1000-18	19	44	56.6	16.5	81.5	44.4	90	45	30.5	226.4	6.3	1,920.60	
TTL1000-20	21	44	56.6	16.5	81.5	44.4	90	45	30.5	226.4	6.3	1,906.60	