

Round jaws for accurate ID measurement

Long Jaw Vernier Caliper SERIES 534

- Long jaws for measuring hard-to-reach workpiece features.
- Inside and outside measurements can be read directly from the upper and lower vernier scales.
- Inside measurement is possible upwards from the minimum inside measuring length (jaws closed).

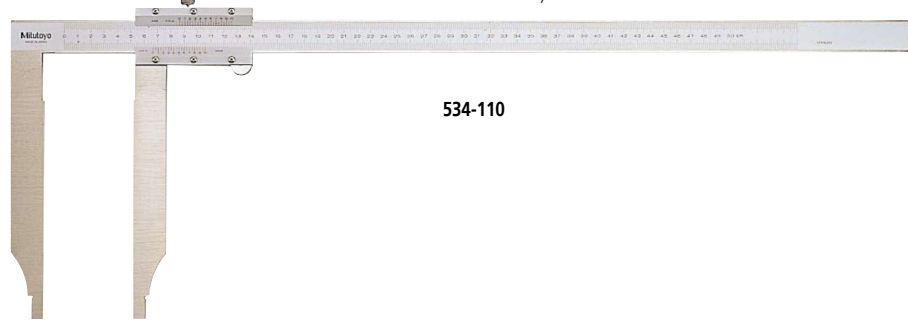

534-110

SPECIFICATIONS

Metric with inside measurement vernier scale

Order No.	Range (mm)*	Graduation (mm)	Accuracy (mm)	Remarks
534-109	0 (10.1) - 300	0.05	±0.07	without fine adjustment
534-110	0 (20.1) - 500		±0.13	

* (): Minimum dimension in inside measurement

Metric / Inch with metric/inch double scale

Order No.	Range (mm)*	Graduation	Accuracy (mm)	Remarks
534-101	0 (10.1) - 300	0.05 mm/1/128 in	±0.07	+10 mm/0.394 in to reading in inside measurement without fine adjustment
534-105		0.02 mm/0.001 in	±0.04	
534-102	0 (20.1) - 500	0.05 mm/1/128 in	±0.13	+20 mm/0.787 in to reading in inside measurement without fine adjustment
534-106		0.02 mm/0.001 in	±0.06	
534-103	0 (20.1) - 750	0.05 mm/1/128 in	±0.16	
534-107		0.02 mm/0.001 in	±0.08	
534-104	0 (20.1) - 1000	0.05 mm/1/128 in	±0.20	
534-108		0.02 mm/0.001 in	±0.10	

* (): Minimum dimension in inside measurement

Note: For external dimensions, refer to the series 534 on page D-23.

D

Calipers

An industry standard measuring tool

Long Jaw Vernier Caliper SERIES 534

- Long jaws for measuring hard-to-reach workpiece features.
- Inside and outside measurements can be read directly from the upper and lower vernier scales.
- The fine-adjustment wheel enables precise feed and adjustment.
- Inside measurement is possible upwards from the minimum inside measuring length (jaws closed).

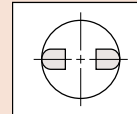
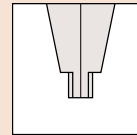
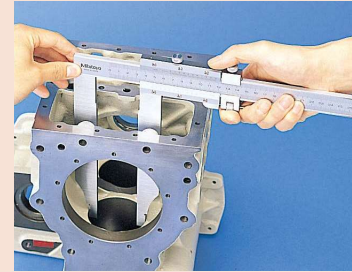

Radiused jaws for accurate ID measurement

SPECIFICATIONS

Metric with inside measurement vernier scale				
Order No.	Range (mm)*	Graduation (mm)	Accuracy (mm)	Remarks
534-113	0 (10.1) - 300	0.02	±0.04	with fine adjustment
534-114	0 (20.1) - 500		±0.06	
534-115	0 (20.1) - 750		±0.08	
534-116	0 (20.1) - 1000		±0.10	

* () : Minimum dimension in inside measurement

Inch with inside measurement vernier scale				
Order No.	Range (in)*	Graduation (in)	Accuracy (in)	Remarks
534-117	0 (0.304) - 12	0.001	±0.002	with fine adjustment
534-118	0 (0.804) - 20		±0.003	
534-119	0 (0.804) - 30		±0.004	
534-120	0 (0.804) - 40			

* () : Minimum dimension in inside measurement

DIMENSIONS

Unit: mm

Range	D	E	F	H	L	M	R	S	t
0 - 300 mm*	90	76.5	—	20	445	7	R5	12	3.8
0 - 300 mm/0 - 12 in		103	38				R5		3.8
0 - 500 mm*	200	89	—	25	682	12	R10	18.5	6
0 - 500 mm/0 - 20 in		112	51				R10		6
0 - 750 mm*	150	—	—	32	995	12	R10	18.5	8
0 - 750 mm/0 - 30 in							62.5		R10
0 - 1000 mm*	150	—	—	32	1230	12	R10	18.5	8
0 - 1000 mm/0 - 40 in							62.5		R10

* Without fine adjustment