

HDB3w-125 Molded Case Circuit Breaker

IEC/EN60947-2



HDB3w-125 Molded Case Circuit Breaker has The Following Features

- Short circuit protection
- Overload protection
- Isolating function

Main Features

Rated operating voltage (V)	1P: 230VAC 2P,3P,4P: 400VAC
Rated current (A)	63-125
Rated frequency (Hz)	50/60
Poles	1P,2P,3P,4P
Breaking capacity (kA)	6, 10



Product Details Display

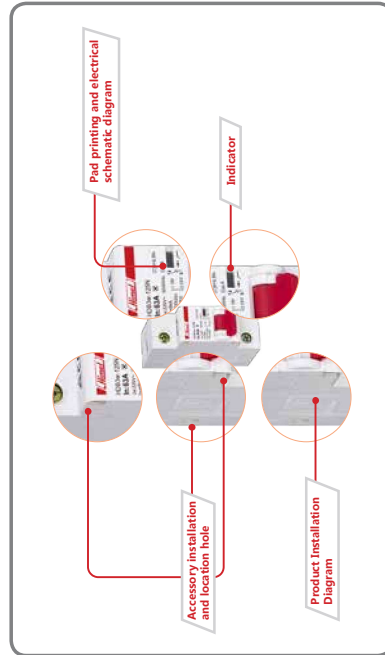

HDB3w-125 Molded Case Circuit Breaker

IEC/EN60947-2



Electrical Characteristics

Rated insulation voltage U_i	(V)	250 (phase-to-ground) / 500 (phase-to-phase)
Rated working voltage U_{Bmax}	1P	230VAC
	2P,3P,4P	400VAC
Rated short-circuit capacity I_{cn} (IEC/EN60898)	(kA)	6, 10
Rated impulse withstand voltage	(kV)	4
Dielectric test voltage		2kV (50/60Hz, 1 minute)
Isolating function		Available
Pollution class		2
Tripping type		Thermal magnetic tripping
Thermal magnetic trip characteristics	C curve ($I_t=8.5I_n$)	■
	D curve ($I_t=12I_n$)	■
Electrical and mechanical accessories		■

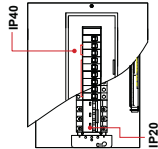
DIN
35 mmInstalled on 35mm
standard guide rail

IP40

IP20

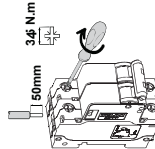

3.6 N.m

50mm

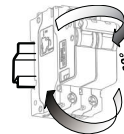

...360°

Flexible installation
direction

Mechanical characteristics

Handle		Red, pad printing indicating ON-OFF position
Mechanical life	Times	8500 times ($I_{ns}=100A$) 7000 times ($I_{ns}>100A$)
Electrical life	Times	1500 times ($I_{ns}=100A$) 1000 times ($I_{ns}>100A$)
Protection rating		Installed in distribution box IP40 Installed directly IP20
Mechanical shock resistance		30g, 3 shocks, last for 11ms (Places with no significant vibration or shock)
Anti-vibration (IEC/EN 60947-2)		Places with no significant vibration or shock
Reference ambient temperature	°C	30°C
Operating ambient temperature (daily mean temperature: +35°C)	°C	-20°C ~+60°C
Storage temperature	°C	-40°C ~+70°C

HDB3w-125 Molded Case Circuit Breaker

IEC/EN60947-2



Installation features

Terminal type	Tunnel terminal
Maximum wiring capacity	(A) Current ratings 63:125/50mm ²
Maximum ultimate torque	(A) Current ratings 63:125:3.5N.m
Tools	Cross head screwdriver or flathead screwdriver
Installation	Installed on standard DIN guide rail (35mm)
Line incoming mode	Top or bottom

Temperature (C)

Rated value Current (A)	-20	-10	0	10	20	30	40	50	60
63	78.8	75.6	72.5	69.3	66.2	63	59.2	56.1	53
80	100	96	92	88	84	80	75.2	71	67
100	125	120	115	110	105	100	94	88	80
125	169.2	162.8	143.8	137.5	131.2	125	117.8	111.5	105

HDB3w-125 Molded Case Circuit Breaker

IEC/EN60947-2



HDB3w-125 Molded Case Circuit Breaker

Product name	Breaking capacity	Poles	Trip type	Rated current
HDB3w-125	N	1	C	63
	N:6KA H:10KA	1: 1P 2: 2P 3: 3P 4: 4P	C: C curve (I _{tr} =8.5In) D: D curve (I _{tr} =12In)	63: 63A 80: 80A 100: 100A 125: 125A

HDB3w-125 Breaking capacity	Pole	Rated current	Trip type			
			C	D		
6KA	1P	63	HDB3w125N1C63	HDB3w125N1D63		
		80	HDB3w125N1C80	HDB3w125N1D80		
	100	HDB3w125N1C100	HDB3w125N1D100			
	125	HDB3w125N1C125	HDB3w125N1D125			
2P	2	63	HDB3w125N2C63	HDB3w125N2D63		
		80	HDB3w125N2C80	HDB3w125N2D80		
	100	HDB3w125N2C100	HDB3w125N2D100			
	125	HDB3w125N2C125	HDB3w125N2D125			
3P	3	63	HDB3w125N3C63	HDB3w125N3D63		
		80	HDB3w125N3C80	HDB3w125N3D80		
	100	HDB3w125N3C100	HDB3w125N3D100			
	125	HDB3w125N3C125	HDB3w125N3D125			
4P	4	63	HDB3w125N4C63	HDB3w125N4D63		
		80	HDB3w125N4C80	HDB3w125N4D80		
	100	HDB3w125N4C100	HDB3w125N4D100			
	125	HDB3w125N4C125	HDB3w125N4D125			



HDB3w-125 Molded Case Circuit Breaker

IEC/EN60947-2



HDB3w-125 Molded Case Circuit Breaker

IEC/EN60947-2



HDB3w-125 Molded Case Circuit Breaker

HDB3w-125 Breaking capacity 10kA	Pole	Rated current	Trip type	
			C	D
	1P	63	HDB3w125H1C63	HDB3w125H1D63
		80	HDB3w125H1C80	HDB3w125H1D80
		100	HDB3w125H1C100	HDB3w125H1D100
		125	HDB3w125H1C125	HDB3w125H1D125
	2P	63	HDB3w125H2C63	HDB3w125H2D63
		80	HDB3w125H2C80	HDB3w125H2D80
		100	HDB3w125H2C100	HDB3w125H2D100
		125	HDB3w125H2C125	HDB3w125H2D125
	3P	63	HDB3w125H3C63	HDB3w125H3D63
		80	HDB3w125H3C80	HDB3w125H3D80
		100	HDB3w125H3C100	HDB3w125H3D100
		125	HDB3w125H3C125	HDB3w125H3D125
	4P	63	HDB3w125H4C63	HDB3w125H4D63
		80	HDB3w125H4C80	HDB3w125H4D80
		100	HDB3w125H4C100	HDB3w125H4D100
		125	HDB3w125H4C125	HDB3w125H4D125

