

Non-telecentric Macro Lens for C-mount Cameras

VS-MC Series

- Lineup of 4 models with magnifications ranging from 0.1x to 1.0x and WD ranging from 82.4 to 325.5 mm.
- 16-mm-dia. simple mechanism with high resistance to vibration.



Ordering Information

Recommend camera	Model	Dimensions	Magnification	Effective FNO	O/I (mm)	WD (mm)	Depth of field *1 (mm)	Resolution *2 (μm)	TV distortion
FZ-S□ FZ-SH□ FH-S□ FH-S□X FZ-S□2M FZ-S□5M3 FH-S□05R FH-S□X05 FHV7H-□	3Z4S-LE VS-MC01-330	A	0.1x	4.43	364.5	325.5	35.4	30.5	0.01% max.
	3Z4S-LE VS-MC03-180	B	0.3x	5.29	248.5	184.8	4.7	11.6	0.00% max.
	3Z4S-LE VS-MC05-130	C	0.5x	6.10	198.8	126.3	2.0	8.2	0.00% max.
	3Z4S-LE VS-MC1-80	D	1.0x	8.14	176.8	82.4	0.7	5.5	0.00% max.

*1. Calculated using a permissible circle of confusion diameter of 0.04 mm.

*2. Calculated using a wavelength of 550 nm.

Camera and Field of View Table

Camera	Size of image element (inch)	Imaging area H×V (mm)	Field of view H×V (mm)			
			0.1× (VS-MC01-330)	0.3× (VS-MC03-180)	0.5× (VS-MC05-130)	1.0× (VS-MC1-80)
FH-S□/FZ-S□/FZ-SH□	1/3" equivalent	4.8 × 3.6	48.0 × 36.0	16.0 × 12.0	9.6 × 7.2	4.8 × 3.6
FH-S□X	1/2.9" equivalent	5.0 × 3.8	50.0 × 38.0	16.7 × 12.7	10.0 × 7.6	5.0 × 3.8
FH-S□05R	1/2.5" equivalent	5.7 × 4.3	57.0 × 43.0	19.0 × 14.3	11.4 × 8.6	5.7 × 4.3
FZ-S□2M	1/1.8" equivalent	7.0 × 5.3	70.0 × 53.0	23.3 × 17.7	14.0 × 10.6	7.0 × 5.3
FH-S□X05/FZ-S□5M3	2/3" equivalent	8.4 × 7.1	84.0 × 71.0	28.0 × 23.7	16.8 × 14.2	8.4 × 7.1
FHV7H-□004-C	1/2.9" equivalent	5.0×3.8	50.0×38.0	16.7×12.7	10.0×7.6	5.0×3.8
FHV7H-□016-C	1/2.9" equivalent	5.0×3.8	50.0×38.0	16.7×12.7	10.0×7.6	5.0×3.8
FHV7H-□032-C	1/1.8" equivalent	7.1×5.3	71.0×53.0	23.7×17.7	14.2×10.6	7.1×5.3
FHV7H-□050-C	2/3" equivalent	8.5×7.1	85.0×71.0	28.3×23.7	17.0×14.2	8.5×7.1
FHV7H-□063R-C	1/1.8" equivalent	7.4×5.0	74.0×50.0	24.7×16.7	14.8×10.0	7.4×5.0
FHV7H-□120R-C	1/1.7" equivalent	7.4×5.6	74.0×56.0	24.7×18.7	14.8×11.2	7.4×5.6

Note: The field of view is a calculated value and not a guaranteed value.

Dimensions

(Unit:mm)

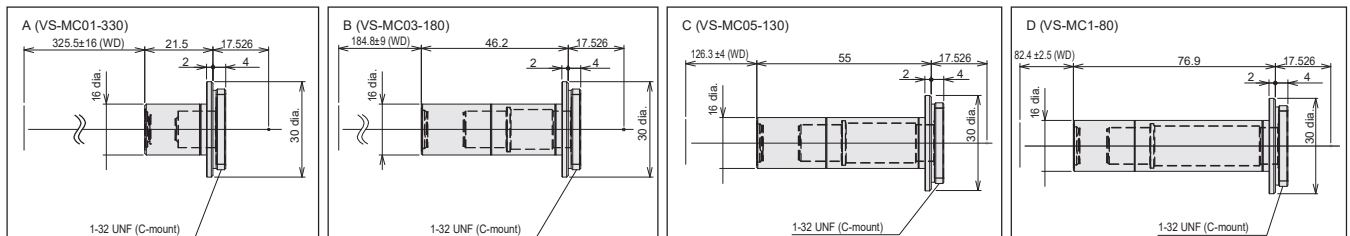

Specifications

Mounting	C mount
Ambient temperature	Operating: 0 to 50°C, Storage: -10 to 60°C (with no icing or condensation)
Ambient humidity	Operating: 35% to 80%, Storage: 35% to 90% (with no condensation)