

# Fuses



## RL1 Screw Type Fuse

### 1. General

- 1.1 Electric ratings: AC400V (380V), up to 200A;
- 1.2 Application: for protection of electric circuits;
- 1.3 Standard: IEC 60269.

### 2. Type Designation

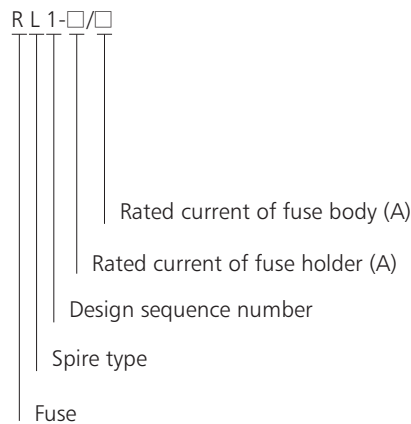

### 3. Technical Data

Fusing rated current	≤6	10	15	20	25	32	50	60	80	100	200
Fusing dissipated power	2.3	2.6	2.8	3.3	4.0	5.2	6.5	7.0	8.0	9.0	13.6

Note: The situation is allowed that the value doesn't exceed 1.2 times of these data.

Model	Rated voltage (V)	Rated current of fuse accessories (A)	Rated current of fuse (A)	Rated breaking capacity (kA)	COS φ
RL1-15	380	15	2, 4, 6, 10, 15	50	0.1~0.2
RL1-60		60	20, 25, 30, 35, 40, 50, 60	50	0.1~0.2
RL1-100	400	100	60, 80, 100	50	0.1~0.2
RL1-200		200	100, 150, 200	50	0.1~0.2

### 4. Overall and Mounting Dimensions

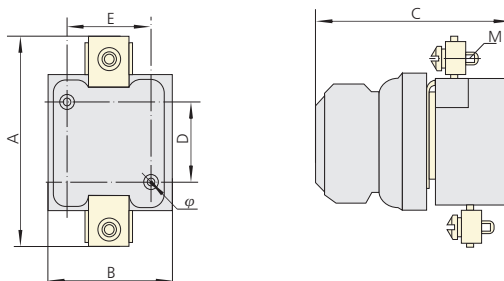

Model	Rated current of fuse accessories(A)	A	B	C	D	E	φ
RL1-15	15	63±2.4	39±2	62±2.4	28±0.8	24±0.8	5 <sup>+0.55</sup> <sub>-0.2</sub>
RL1-60	60	78±2.5	55±2.4	77±2.5	40±1.0	34±1.0	6 <sup>+0.5</sup> <sub>-0.4</sub>
RL1-100	100	118±2.5	82±2.8	113±2.5	54±1.2	46±1.0	8 <sup>+0.5</sup> <sub>-0.4</sub>
RL1-200	200	155±2.4	105±2	107±2.4	60±1	60±1	10±0.75