

- 3 : 3P
- 4 : 4P

# PC Type

## ATS(800~6300A)



### ◆ Information to Order\_ 주문정보

OSS - 6  - PC -  -  P -

A                      B                      C                      D

**A** Rated Current

08	10	12	16	20	25	32	40	50	63
800A	1000A	1250A	1600A	2000A	2500A	3200A	4000A	5000A	6300A

**B** Connection (접속방식)

- F : Fixed (고정형)
- D : Draw-out (인출형)

**C** Number of Poles

- 3 : 3P
- 4 : 4P

**D** Operating Voltage

- A1 : AC 110V    ● D1 : DC 110V
- A2 : AC 220V    ● D2 : DC 125V

### ◆ External View\_ 외관명칭

①	Arc-Extinguishing Chamber (소호실)
②	Manual Lever Inlet (수동 레버 삽입구)
③	Manual Lever (수동 레버)
④	Name Plate (명판)
⑤	Lifting Hook (견인고리)
⑥	Circuit Diagram (회로도)
⑦	ON-OFF Indicator (절체상태표시기)
⑧	Terminal Block (단자대) - Product below 1600A are connector (1600A 이하 제품은 커넥터입니다.)

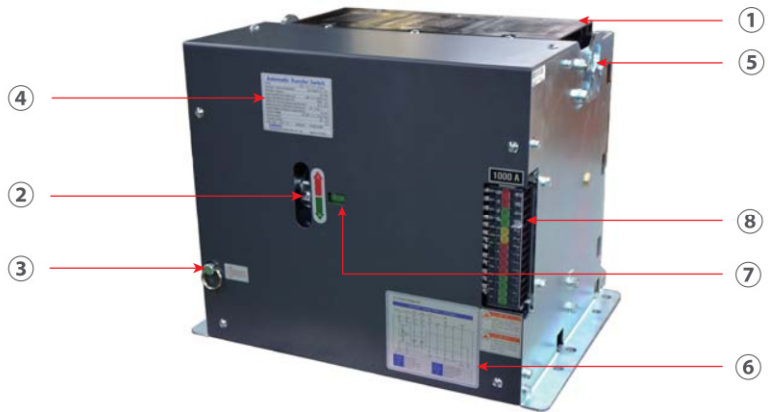

### ◆ Features\_ 특징

**Transfer method (2-Position ATS)**

A ⇒ B, B ⇒ A

**One coil mechanism**

One coil mechanism is applied

**Transfer indicator provided**

Transfer indicator is fitted to indicate the transfer status.

**Easier busbar arrangement**

If the ATS is installed with the ACB in switchgear, Busbar can be easily arranged.

**Fixed Type & Drawout Type available**

Fixed Type and Drawout Type, Can satisfy a variety of customer needs.

**Quick replacement of ATS**

If malfunction occurs, Drawout Type of ATS can be changed within 5 minutes.

**Perfect transfer mechanism**

By spring transfer mechanism, ATS can be completely and perfectly transferred. There will be NO unattached position in any case.

**Sufficient current capacity**

Sufficient current carrying contacts are designed to withstand against over current.

**Minimized opening & closing impact**

Opening and closing impact is minimized.

**Last Break, 1st make Neutral contact**

Last Break, 1st make Neutral contact to reduce nuisance tripping in the ground fault protection system. IEC 60947-1 (Clause 7.1.9)

See page 65 for calculation of TR capacity for operation.

■ 절체 방식 (2-Position ATS)

A ⇒ B, B ⇒ A

■ 1 코일 절체 기구

정평이 있는 순시 여자 방식의 1 코일 절체 기구를 채택했습니다.

■ 절체 표시기 부착

절체의 상태를 확인할 수 있는 절체 표시기를 부착하였습니다.

■ 부스바 작업 간편

ACB와 함께 배전반 설치 시 부스바 작업이 간편합니다.

■ 다양한 고객요구 만족

고정형과 인출형이 있어 다양한 고객요구를 만족시킬 수 있습니다.

■ ATS 교체시간 단축

인출형의 경우, 사고 발생 시 ATS 교체시간은 5분 이하입니다.

■ 불완전 투입요소 완전 제거

스프링 절체방식에 의해서 완전하고 완벽한 절체가 되도록 하였습니다. 양쪽 전원 중 어느 한쪽으로 반드시 접촉되도록 구조가 이루어져 있습니다.

■ 접점부 과전류 설계

통전부의 독특한 접점구조에 의해서 과전류에 충분히 이겨낼 수 있도록 설계되어 있습니다.

■ 개폐 쇼크 미미

개폐 조작 시 개폐 쇼크가 극소합니다.

■ 중성선 선 투입 후 개방

투입 시 중성선이 삼상(L1, L2, L3)보다 먼저 투입되고 개방 시 나중에 끊어지는 구조로 순간적으로 중성선이 개방되어 발생될 수 있는 사고를 방지. (IEC 60947-1 Clause 7.1.9)

■ 조작용 TR 용량 선정은 65 페이지 참조



## ATS(800~6300A)

### ◆ Specification\_ 정격사양

TYPE		608-PC		610-PC		612-PC		616-PC		620-PC			
Rated Operational Voltage (정격사용전압)	Ue	AC 600V											
Rated Insulation Voltage (정격절연전압)	Ui	AC 800V											
Rated Current (정격전류)	Ie	800 A		1000 A		1250 A		1600 A		2000 A			
Neutral Phase Current (중성극전류)		800 A		1000 A		1250 A		1600 A		2000 A			
Kind of Throw (투수)		Double Throw (쌍투)											
Connection (접속방식)		Back (배면)											
Number of Poles (극수)		3P	4P	3P	4P	3P	4P	3P	4P	3P	4P		
Weight (중량 : kg)	Fixed (고정)	52	58	52	58	55	63	57	67	85	115		
	Draw-out (인출)	86	104	86	104	94	115	102	120	135	180		
Rated Short-Time Withstand Current (정격 단시간 내전류)	Icw	25 kA		30 kA		35 kA		40 kA					
Rated Short-Circuit Making Capacity (단락 투입 전류) peak	Icm	52.5 kA		63 kA		73.5 kA		84 kA					
Switching Capacity (개폐용량)		AC -33B											
Switching Frequency (개폐빈도)		60 Time / Hour				20 Time / Hour				10 Time / Hour			
Operating Current (조작전류) peak	DC 110V ~ 125V	45 A				50 A				65 A			
	AC 100V ~ 110V	45 A				50 A				65 A			
	AC 200V ~ 240V	30 A				40 A				50 A			
Operating Time (동작시간)	Operating Transfer Time	AC Control ≤ 120 ms / DC Control ≤ 150 ms								≤ 150ms / ≤ 180ms			
	Opening Time	AC Control ≤ 90 ms / DC Control ≤ 120 ms								≤ 120ms / ≤ 150ms			
	Contact Transfer Time	≤ 30 ms										≤ 25 ms	
Number of Operating Cycles (정격 개폐 회수)	Without Current (무통전)	10,000										5,000	
	With Current (통전)	5,000										3,000	

Cautions (주의사항)

1. For complete operation, Be sure to provide control source for more than 0.5sec.
  2. When control source will be provided to A side and B side simultaneously, Coil may be damaged.
1. 조작지령은 0.5sec 이상으로 하여 확실한 동작을 할 수 있도록 하여 주십시오.  
2. A측, B측 동시 조작 지령 시 코일 소손의 원인이 됩니다.

TYPE		625-PC		632-PC		640-PC		650-PC		663-PC			
Rated Operational Voltage (정격사용전압)	Ue	AC 600V											
Rated Insulation Voltage (정격절연전압)	Ui	AC 800V											
Rated Current (정격전류)	Ie	2500 A		3200 A		4000 A		5000 A		6300 A			
Neutral Phase Current (중성극전류)		2500 A		3200 A		4000 A		5000 A		6300 A			
Kind of Throw (투수)		Double Throw (쌍투)											
Connection (접속방식)		Back (배면)											
Number of Poles (극수)		3P	4P	3P	4P	3P	4P	3P	4P	3P	4P		
Weight (중량 : kg)	Fixed (고정)	92	123	98	133	164	203	191	235	191	235		
	Draw-out (인출)	158	203	171	217	265	330	340	400	340	400		
Rated Short-Time Withstand Current (정격 단시간 내전류)	Icw	50 kA				65 kA							
Rated Short-Circuit Making Capacity (단락 투입 전류) peak	Icm	105 kA				143 kA							
Switching Capacity (개폐용량)		AC -33B											
Switching Frequency (개폐빈도)		10 Time / Hour											
Operating Current (조작전류) peak	DC 110V ~ 125V	65 A				80 A							
	AC 100V ~ 110V	65 A				80 A							
	AC 200V ~ 240V	50 A				65 A							
Operating Time (동작시간)	Operating Transfer Time	AC Control ≤ 150 ms / DC Control ≤ 180 ms											
	Opening Time	AC Control ≤ 120 ms / DC Control ≤ 150 ms											
	Contact Transfer Time	≤ 25 ms											
Number of Operating Cycles (정격 개폐 회수)	Without Current (무통전)	5,000										3,000	
	With Current (통전)	3,000										1,500	

Cautions (주의사항)

1. For complete operation, Be sure to provide control source for more than 0.5sec.
  2. When control source will be provided to A side and B side simultaneously, Coil may be damaged.
1. 조작지령은 0.5sec 이상으로 하여 확실한 동작을 할 수 있도록 하여 주십시오.  
2. A측, B측 동시 조작 지령 시 코일 소손의 원인이 됩니다.

# PC Type

## ATS(800~6300A)



### ◆ Outline Dimension\_ 외형도

#### 800~1600A Fixed

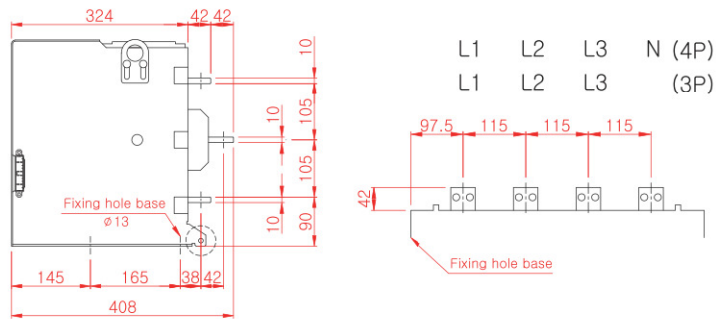
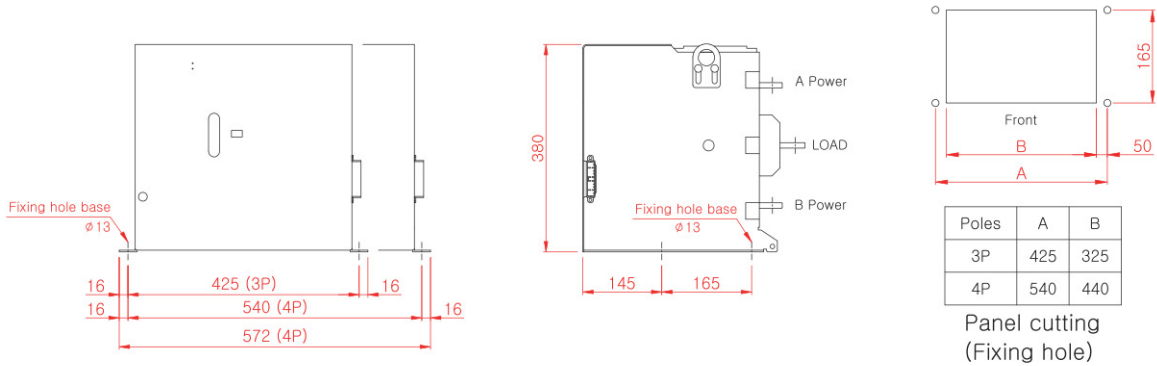

#### OSS-608~610-PC

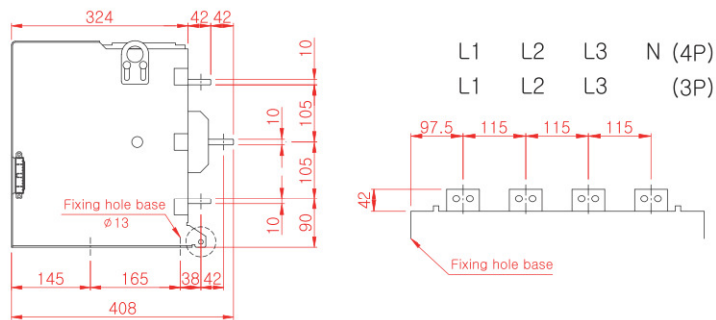
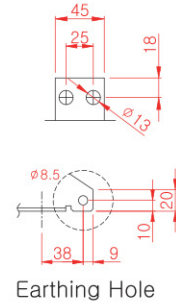

#### OSS-612-PC

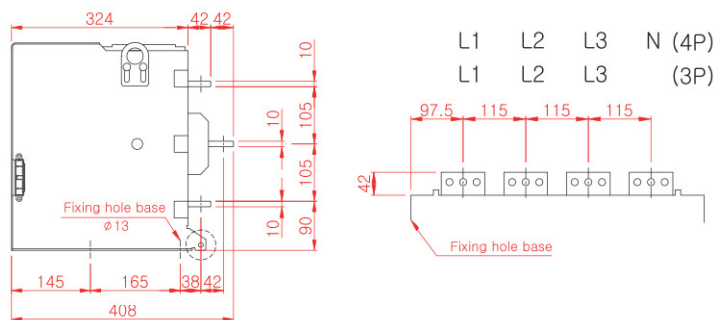
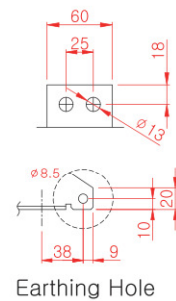

#### OSS-616-PC

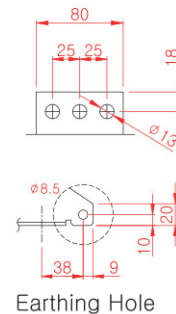

# PC Type

## ATS(800~6300A)



### ◆ Outline Dimension\_ 외형도

#### 2000~3200A Fixed

Unit : mm

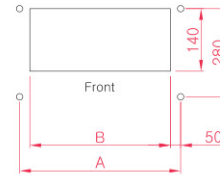
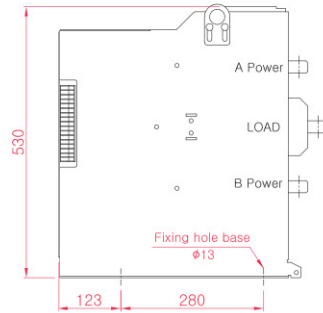
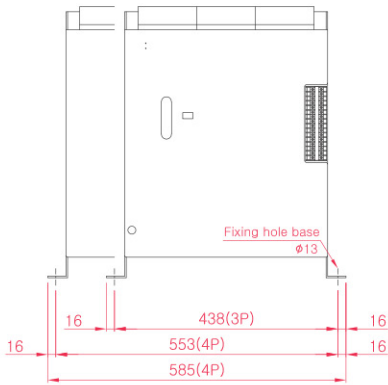

Poles	A	B
3P	438	338
4P	553	453

Panel Cutting  
(Fixing Hole)

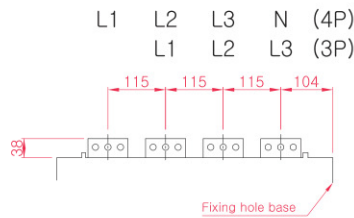
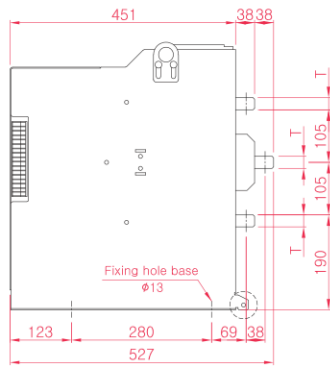

#### OSS-620~625-PC

Current	T
2000A	15
2500A	24

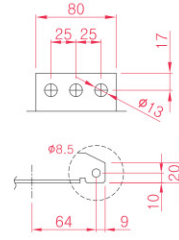

Earthing Hole

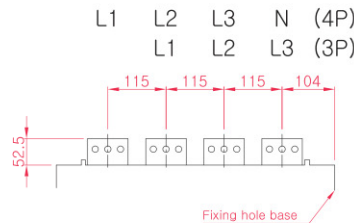
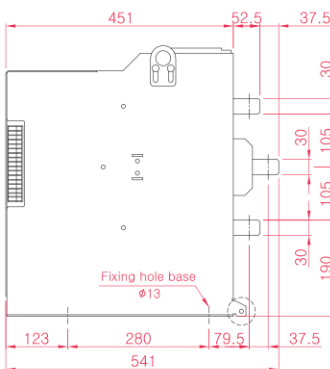

#### OSS-632-PC

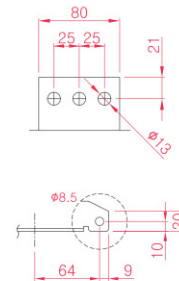

Earthing Hole

# PC Type

ATS(800~6300A)



## ◆ Outline Dimension\_ 외형도

4000~6300A Fixed

Unit : mm

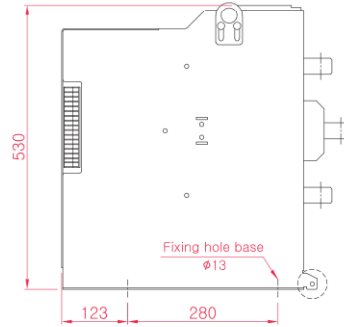
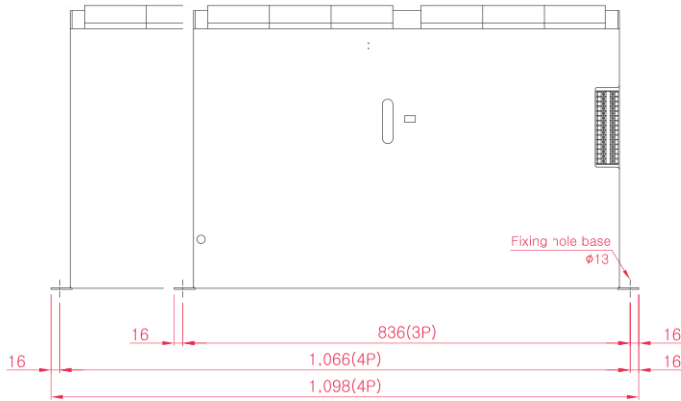

### OSS-640-PC

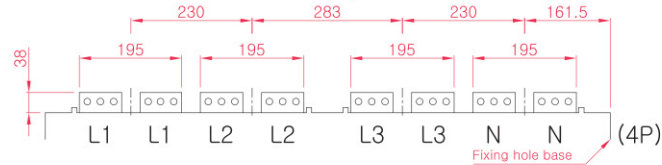
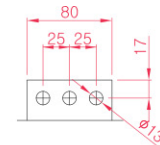
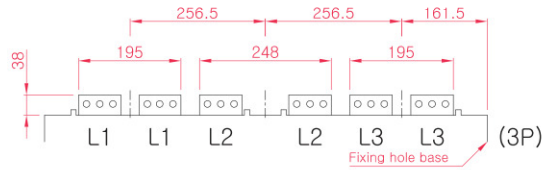
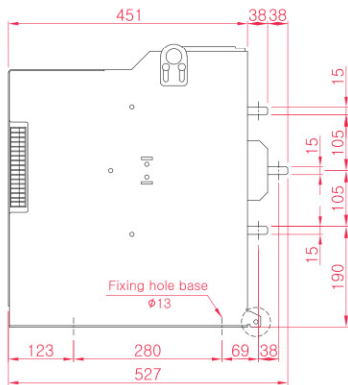

### OSS-650~663-PC

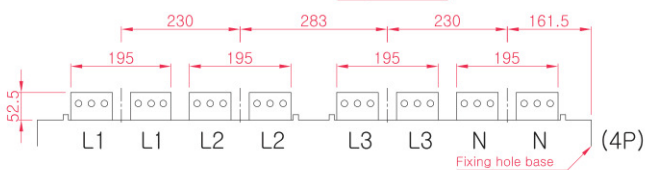
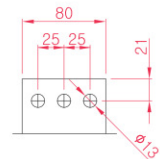
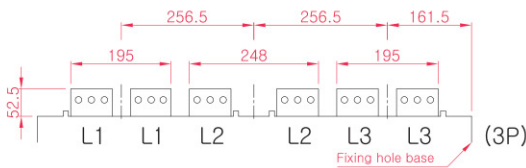
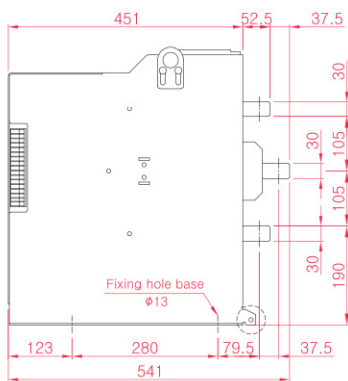

### Panel cutting (Fixing hole)

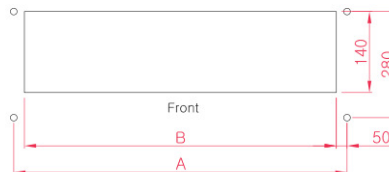

Poles	A	B
3P	834	734
4P	1064	964

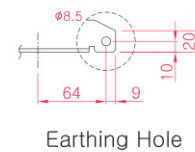

Earthing Hole

# PC Type

ATS(800~6300A)



## ◆ Outline Dimension\_ 외형도

### 800~1600A Draw-out

Unit : mm

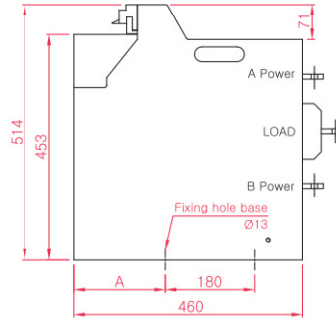
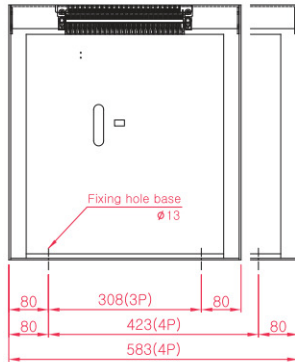

POSITION	A
CONNECTED	184
TEST	225
DISCONNECTED	254

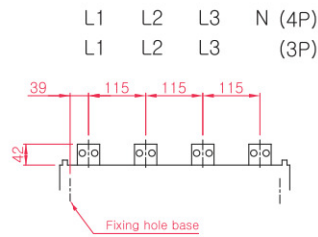
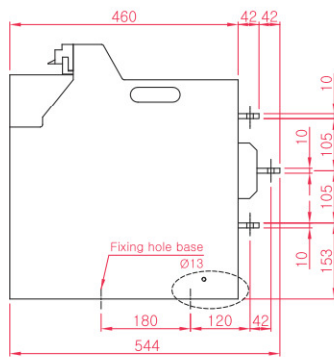

### OSS-608~610-PC

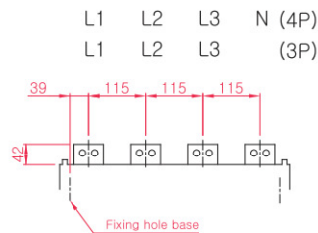
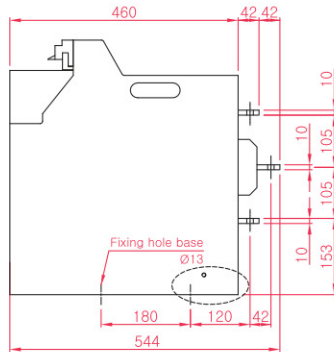
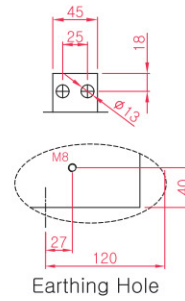

### OSS-612-PC

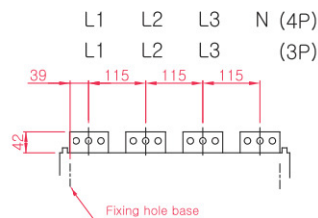
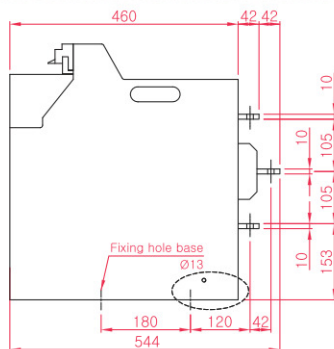
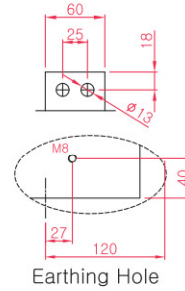

### OSS-616-PC

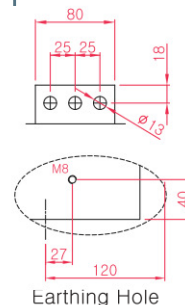

# PC Type

ATS(800~6300A)



## ◆ Outline Dimension\_ 외형도

2000~3200A Draw-out

Unit : mm

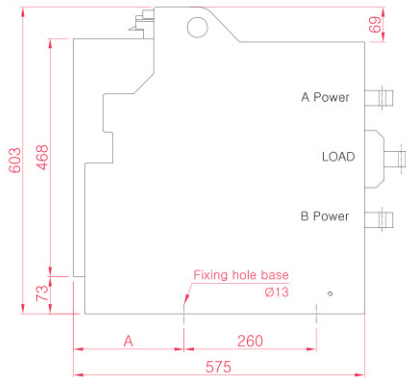
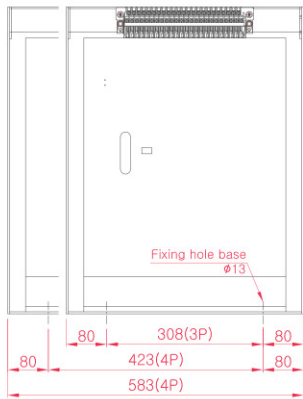

POSITION	A
CONNECTED	220
TEST	261
DISCONNECTED	290

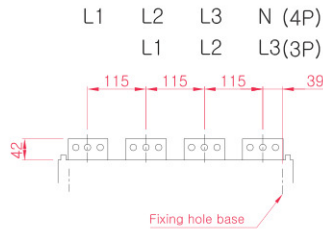
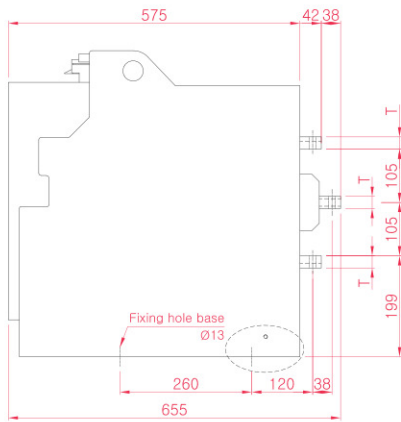

Current	T
2000A	15
2500A	24

### OSS-620~625-PC

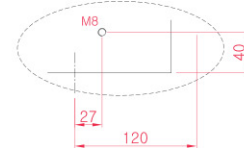
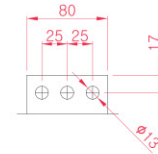

Earthing Hole

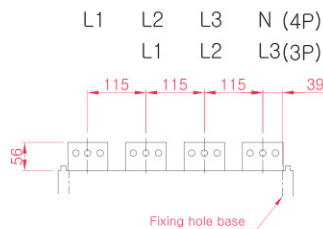
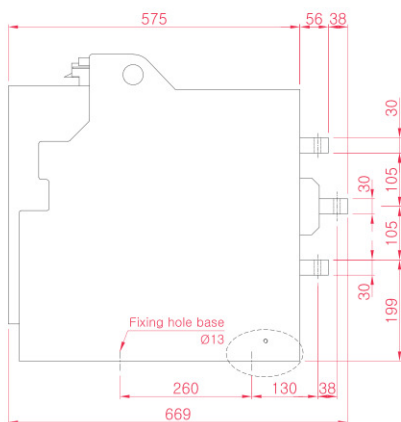

### OSS-632-PC

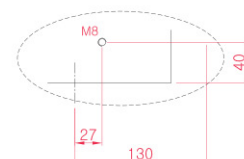
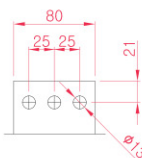

Earthing Hole

# PC Type

## ATS(800~6300A)



### ◆ Outline Dimension\_ 외형도

### 4000~6300A Draw-out

Unit : mm

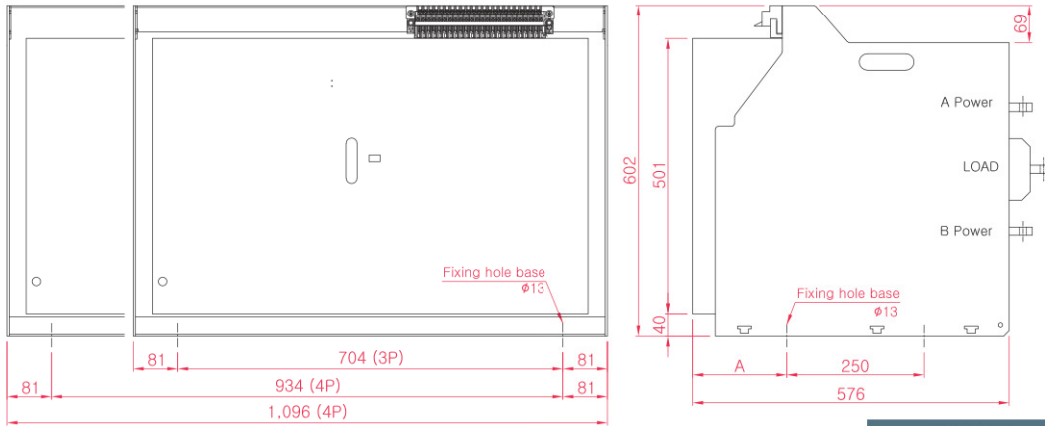

POSITION	A
CONNECTED	171
TEST	212
DISCONNECTED	241

