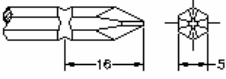
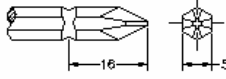

## ※ Specifications

MODEL	SK-8130L	SK-8140L SK-8140LF	SK-8150L	SK-8130LF	SK-8230L	SK-8240L SK-8240LF	SK-8250L	SK-8230LF	
Input voltage(AC)	AC 110V~120V 50Hz/60Hz				AC 220~240V 50Hz/60Hz				
Rated input	68W								
Bit torque	(kgf.cm)	5-22	10-30	15-45	5-17	5-22	10-30	15-45	5-17
	(Lbf.in)	4.34-19.12	8.67-26.02	13-39.02	4.34-14.78	4.34-19.12	8.67-26.02	13-39.02	4.34-14.78
	(N.m)	0.49-2.16	0.98-2.94	1.47-4.41	0.49-1.67	0.49-2.16	0.98-2.94	1.47-4.41	0.49-1.67
Torque Accuracy (%)	±3%								
Torque Adjustment	Step less								
Rev speed at no load ( R.p.m)	1000	700	500	1900	1000	700	500	1900	
		1000				1000			
Non-power Consumption (A)	0.4A				0.3A				
Metal assembly screw(mm)	Machine screw	2.6~4.0	3.0~5.0	4.0~6.0	2.3-3.5	2.6~4.0	3.0~5.0	4.0~6.0	2.3-3.5
	Tapping screw	2.0~3.5	2.6~4.0	3.0~5.0	2.0~3.0	2.0~3.5	2.6~4.0	3.0~5.0	2.0~3.0
Weight (g)	700								
Length (mm)	269								
Model of Torque Fixing Ring	KC-1								
Model of Suspension Rack	KH-3、(KC & KH-1)								
Bit Type	 HEX 5mm,				 HEX 6.35mm				

1N.m=10.2Kgf.cm 1N.m=8.85Lbf.in

## ※ Accessories

1. BIT Type : No. 00 ... Bit use in dia 1.3~1.8mm screw  
                   No. 0 ... Bit use in dia 1.8~2.0mm screw  
                   No. 1 ... Bit use in dia 2.0~2.6mm screw  
                   No. 2 ... Bit use in dia 3.0~4.0mm screw  
                   SK-8130L ; SK-8230L with BIT 1# & 2# 1 Pcs Each.  
                   SK-8140L ; SK-8240L with BIT 2# 2 Pcs.  
                   SK-8150L ; SK-8250L with BIT 2# 2 Pcs  
                   SK-8130LF ; SK-8230LF with BIT 1# & 2# 1 Pcs Each  
                   SK-8140LF ; SK-8240LF with BIT 2# 2 Pcs
2. Suspension rack and Torque fixing ring acceptable for use with the tool are available from KILEWS catalogue.

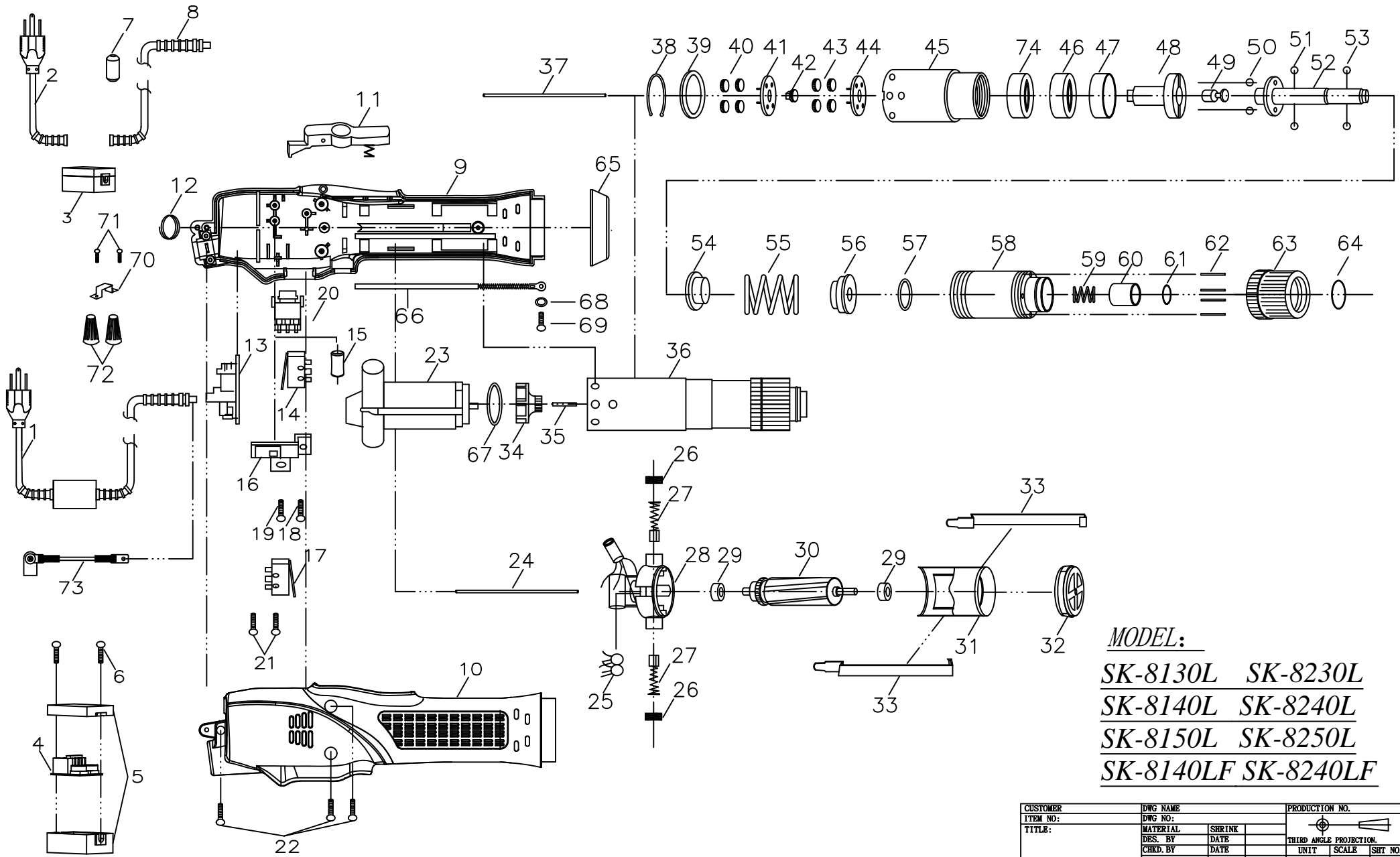

MODEL:  
 SK-8130L SK-8230L  
 SK-8140L SK-8240L  
 SK-8150L SK-8250L  
 SK-8140LF SK-8240LF

CUSTOMER	DWG NAME		PRODUCTION NO.		
ITEM NO:	DWG NO:				
TITLE:	MATERIAL	SHRINK			
	DES. BY	DATE	THIRD ANGLE PROJECTION.		
	CHKD. BY	DATE	UNIT	SCALE	SHT NO.
	APPD. BY	DATE			

NO	PARTS NO	PARTS NAME-E	PARTS NAME-C	O'lv	NO	PARTS NO	PARTS NAME-E	PARTS NAME-C	O'lv
1	AC30001-1	Cord Assv-AMERICA Plug	電源線整組 美規	1		GZ91072-3A	CLUTCH ASSEMBLY FOR 8140LA	離合器整組 8140LA	1
	AF30001-1	Cord Assv-EUROPE Plug	電源線整組 歐規	1		GZ91072-3B	CLUTCH ASSEMBLY FOR 8140LB	離合器整組 8140LB	1
	AG30001-1	Cord Assv-BRITISH Plug	電源線整組 英規	1		GZ92071-3A	CLUTCH ASSEMBLY FOR 8150LA	離合器整組 8150LA	1
	AJ30001-1	Cord Assv-INDIA Plug	電源線整組 印規	1		GZ92071-3B	CLUTCH ASSEMBLY FOR 8150LB	離合器整組 8150LB	1
	AD30001-1Y	Cord Assv-AUSTRALIA Plug	電源線整組 澳規	1		GZ91072-3AF	CLUTCH ASSEMBLY FOR 8140LFA	離合器整組 8140LFA	1
	AC30001-1F	Cord Assv-AMERICA Plug FOR "8140LF,8240LF"	電源線整組 美規 8140LF,8240LF	1		GZ91072-3BF	CLUTCH ASSEMBLY FOR 8140LFB	離合器整組 8140LFB	1
	AF30001-1F	Cord Assv-EUROPE Plug FOR "8140LF,8240LF"	電源線整組 歐規 8140LF,8240LF	1	37	MI31221	PILOT ROD	開關引導棒	1
	AG30001-1F	Cord Assv-BRITISH Plug FOR "8140LF,8240LF"	電源線整組 英規 8140LF,8240LF	1	38	GK91211	"C" RING	齒輪固定 C環	1
	AJ30001-1F	Cord Assv-INDIA Plug FOR "8140LF,8240LF"	電源線整組 印規 8140LF,8240LF	1	39	GI28444-1	IRON WASHER FOR 8130L,8140LF	齒輪固定片 8130L,8140LF	1
	AD30001-1YF	Cord Assv-AUSTRALIA Plug FOR "8140LF,8240LF"	電源線整組 澳規 8140LF,8240LF	1		GI28444	IRON WASHER FOR 8140L,8150L	齒輪固定片 8140L,8150L	1
2	AA30007-1	Cord 1FT with AMERICA Plug	1呎長電源線 美規	1	40	GH20241	IDLE GEAR FOR "8130L"	游星齒輪(8130L)	3
	AA30007-2	Cord 1FT with EUROPE Plug	1呎長電源線 歐規	1		GH91232	IDLE GEAR FOR "8140L"	游星齒輪(8140L)	3
	AA30007-5	Cord 1FT with BRITISH Plug	1呎長電源線 英規	1		GH92231	IDLE GEAR FOR "8150L"	游星齒輪(8150L)	4
	AA30007-5E	Cord 1FT with INDIA Plug	1呎長電源線 印規	1		GH21221-2	IDLE GEAR FOR "8140LF"	游星齒輪(8140LF)	4
	AA30007-1D	Cord 1FT with AUSTRALIA Plug	1呎長電源線 澳規	1	41	GG21231	GEAR SEAT FOR "8130L"	上齒盤(8130L)	1
3	EI30002-2	EMC-BOX ASSEMBLY	EMC盒成品	1		GG20271	GEAR SEAT FOR "8140LF"	上齒盤(8140LF)	1
	EJ30002-5	EMC-BOX ASSEMBLY FOR "8140LF,8240LF"	EMC盒成品 8140LF,8240LF	1		GG91242-1	GEAR SEAT FOR "8140L"	上齒盤含中心齒(8140L)	1
4	EC30006	EMC-BOX	EMC盒	1		GG92241-1	GEAR SEAT FOR "8150L"	上齒盤含中心齒(8150L)	1
5	EG30005-3	P.C.B	PC板	1	42	G20102	CENTRAL GEAR ONLY FOR "8130L"	中心齒(8130L)	1
	EG30005	P.C.B FOR "8140LF,8240LF"	PC板 8140LF,8240LF	1		G20104	CENTRAL GEAR ONLY FOR "8140LF"	中心齒(8140LF)	1
6	CH90152-1F	SCREW	螺絲	2	43	GH20241	IDLE GEAR FOR "8130L"	游星齒輪(8130L)	3
7	ED30004	FILTER	電磁夾	1		GH91232-1	IDLE GEAR FOR "8140L"	游星齒輪(8140L)	3
8	AA30009-1T	CORD 9"	9呎長電源線	1		GH92231-1	IDLE GEAR FOR "8150L"	游星齒輪(8150L)	4
9	CB91107	HOUSING-UNDERSIDE (ORANGE-BL)	下蓋(橙-黑)	1		GH21221-2	IDLE GEAR FOR "8140LF"	游星齒輪(8140LF)	4
10	CA92107	HOUSING-UPSIDE FOR (ORANGE-BL)	上蓋(橙-黑)	1	44	GG21231	GEAR SEAT FOR "8130L"	下齒盤(8130L)	1
11	CC70012	TRIGGER	手按開關桿	1		GG91272-1	GEAR SEAT FOR "8140L"	下齒盤(8140L)	1
12	CI20011	SUSPENSION RING	起子吊環	1		GG92271-1	GEAR SEAT FOR "8150L"	下齒盤(8150L)	1
13	EG91131-3	CONTROL BOARD FOR "110V"	PC板(110V)	1		GG20271	GEAR SEAT FOR "8140LF"	下齒盤(8140LF)	1
	EG91132-1	CONTROL BOARD FOR "220V"	PC板(220V)	1	45	GA91281	GEAR CASE FOR "8130L"	上離合器筒(8130L)	1
14	HB91061	SHUT OFF SWITCH	停止開關	1		GA91282	GEAR CASE FOR "8140L,8150L"	上離合器筒(8140L,8150L)	1
15	E31908	BRAKE RESISTOR FOR 110V	剎車電阻(阻抗)-110V	1		GA91282-1	GEAR CASE FOR "8140LF"	上離合器筒(8140LF)	1
	E31908-4	BRAKE RESISTOR FOR 220V	剎車電阻(阻抗)-220V	1	46	GN21251	MAIN BEARING	離合器主軸承	1
16	CB90101-1	SWITCH BASE	三合一開關架	1	47	GW21531	IRON RING	鐵墊圈	1
17	HB30061	START SWITCH	啟動開關	1	48	GC31321A	CAM	上離合器頭	1
18	CH90121	SCREW	螺絲	1	49	GU30370	STOP PILOT FOR "LA"	停止用酒杯(LA)	1
19	CH90131	SCREW	螺絲	1		GU30371	STOP PILOT FOR "LB"	停止用酒杯(LB)	1
20	HA91041	CHANGEOVER SWITCH FOR "8130L/8230L"	正反開關(8130L/8230L)	1	50	GP30351	STEEL BALLS	跳脫鋼珠	3
	HA91042	CHANGEOVER SWITCH FOR "8140L/8240L"	正反開關(8140L/8240L)	1	51	GP30351	STEEL BALLS 4mm	酒杯鋼珠(4mm)	2
	HA92051	CHANGEOVER SWITCH FOR "8150L/8250L"	正反開關(8150L/8250L)	1	52	GD31351A-1	BIT HOLDER FOR "A"TYPE	傳動軸(A)	1
21	CH90151-1	SCREW	螺絲	2		GD31353B-1	BIT HOLDER FOR "B"TYPE	傳動軸(B)	1
22	CH20102	SCREW	螺絲	3	53	GP21291A	BIT PILOT FOR "A"TYPE	起子頭帽鋼珠(A)	2
23	MO91111	MOTOR ASSEMBLY FOR "110V"	馬達整組(110V)	1		GP21291B	BIT PILOT FOR "B"TYPE	起子頭帽鋼珠(B)	2
	MO91111-2	MOTOR ASSEMBLY FOR "8140LF"	馬達整組(8140LF)	1	54	GF31371	WARNING PLATE FOR "LA"	扭力推盤(LA)	1
	MO91112	MOTOR ASSEMBLY FOR "220V"	馬達整組(220V)	1		GF31372	WARNING PLATE FOR "LB"	扭力推盤(LB)	1
	MO91112-2	MOTOR ASSEMBLY FOR "8240LF"	馬達整組(8240LF)	1	55	GF91381-1	WRING SPRING FOR "8130L"	扭力彈簧(8130L)	1
24	MI31611	PILOT ROD	開關引導棒	1		GF91382-2	WRING SPRING FOR "8140L,8140LF"	扭力彈簧(8140L,8140LF)	1
25	EB33610-2	CERAMICS CAPACITOR	陶瓷電容	2		GF92382-6	WRING SPRING FOR "8150L"	扭力彈簧(8150L)	1
26	MD91531	BRUSH CAP	碳刷蓋	2	56	GY31391	WARNING SPRING BASE-LA	止推盤-LA	1
27	MC21411	CARBON FOR "110V"	碳刷(110V)	2		GY21321	WARNING SPRING BASE-LB	止推盤-LB	1
	MC20161	CARBON FOR "220V"	碳刷(220V)	2	57	GK20231B	C-RING FOR LA TYPE	傳動軸固定C環 LA	1
28	ML91551	MOTOR TOP COVER FOR "110V"	碳刷座(110V)	1	58	GB21331-1	CLUTCH CASE	下離合器筒	1
	ML91552	MOTOR TOP COVER FOR "220V"	碳刷座(220V)	1	59	GO21341	BIT SPRING	起子頭帽彈簧	1
29	ME21481	ARMATURE BEARING	馬達軸承	2	60	GI21351	BIT SLEEVE	起子頭帽	1
30	MH91591	ARMATURE FOR "110V"	電樞(110V)	1	61	GO21361	"C" RING	起子頭帽 C環	1
	MH91591PF	ARMATURE FOR "8140LF"	電樞(8140LF)	1	62	GL21371	TORQUE ADJUST PING	扭力調整棒	4
	MH91592	ARMATURE FOR "220V"	電樞(220V)	1	63	GM21381	TORQUE ADJUST RING	扭力調整環	1
	MH91592-1	ARMATURE FOR "8240LF"	電樞(8240LF)	1	64	GS21391	"C"RING	扭力環 C環	1
31	MI91621	MOTOR YOKE ASSEMBLY	馬達鐵圈連磁鐵	1	65	CD91031-1	COUPLER (BLACK)	前鎖環(黑)	1
	MI91621PF	MOTOR YOKE ASSEMBLY FOR "8140LF,8240LF"	馬達鐵圈連磁鐵(8140LF,8240LF)	1	66	CH30681T	GROUNDING MEANS	接地線	1
32	MB91641A	MOTOR END COVER	馬達前蓋	1	67	ME91101	INSULATING	墊圈	1
33	MA91611B	ASSEMBLING SPRING	馬達固定鐵片	2	68	CH20102-10	WASHER	墊片	1
34	MK21111	FAN FOR "8130L,8230L"	風扇(8130L,8230L)	1	69	CH20102-11	SCREW	螺絲	1
	MK91091	FAN FOR "8140L,8240L"	風扇(8140L,8240L)	1	70	CH20102-2	WIRE CLAMP	線夾	1
	MK92091	FAN FOR "8150L,8250L"	風扇(8150L,8250L)	1	71	CH20102-3	SCREW FOR WIRE CLAMP	線夾螺絲	2
	MK21112	FAN FOR "8140LF,8240LF"	風扇(8140LF,8240LF)	1	72	CH20102-7	WIRE CONNECTER	螺式接頭	2
35	MG91081	PILOT ROD	陶瓷棒	1	73	PI2104	3cm RETAINING CLIP	三分分固定線	1
36	GZ91071-3A	CLUTCH ASSEMBLY FOR 8130LA	離合器整組 8130LA	1	74	GN30442	MAIN BEARING	離合器主軸承	1
	GZ91071-3B	CLUTCH ASSEMBLY FOR 8130LB	離合器整組 8130LB	1					

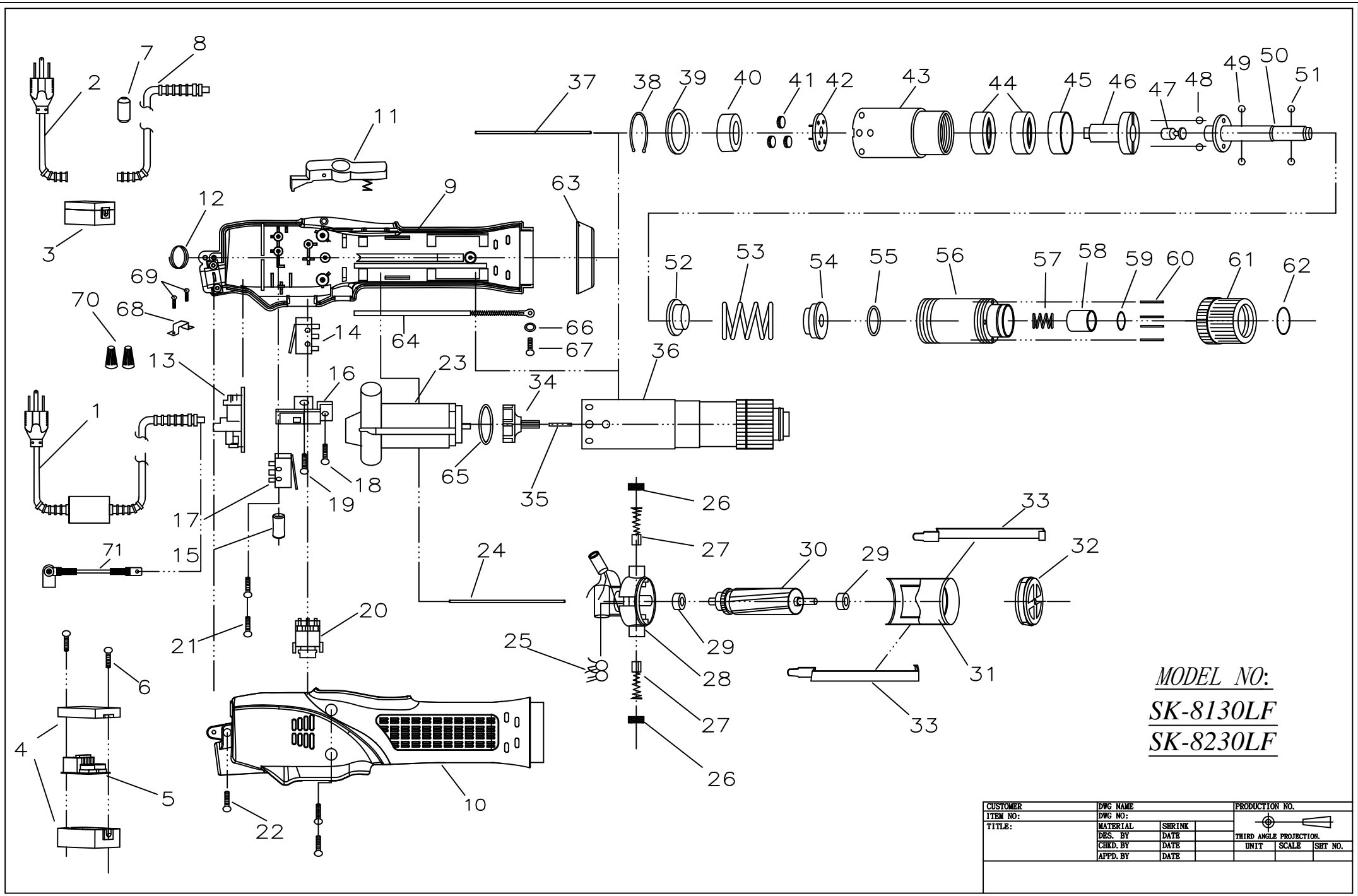

*MODEL NO:*  
***SK-8130LF***  
***SK-8230LF***

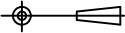
CUSTOMER	DWG NAME			PRODUCTION NO.		
ITEM NO:	DWG NO:					
TITLE:	MATERIAL	SHRINK		THIRD ANGLE PROJECTION		
	DES. BY	DATE		UNIT	SCALE	SHT NO.
	CHKD. BY	DATE				
	APPD. BY	DATE				

NO	PARTS NO	PARTS NAME-E	PARTS NAME-C	Q'ty	NO	PARTS NO	PARTS NAME-E	PARTS NAME-C	Q'ty
1	AC30001-1F	Cord Assy-AMERICA Plug	電源線整組 美規	1	33	MA91611B	ASSEMBLING SPRING	馬達固定鐵片	2
	AF30001-1F	Cord Assy-EUROPE Plug	電源線整組 歐規	1	34	MK21111PF	FAN	風扇	1
	AG30001-1F	Cord Assy-BRITISH Plug	電源線整組 英規	1	35	MG30081-1	PILOT ROD	陶瓷棒	1
	AJ30001-1F	Cord Assy-INDIA Plug	電源線整組 印規	1	36	GZ91071-3AF	CLUTCH ASSEMBLY FOR 8130LFA	離合器整組 8130LFA	1
	AD30001-1YF	Cord Assy-AUSTRALIA Plug	電源線整組 澳規	1		GZ91071-3BF	CLUTCH ASSEMBLY FOR 8130LFB	離合器整組 8130LFB	1
2	AA30007-1	Cord 1FT with AMERICA Plug	1呎長電源線 美規	1	37	MI31221	PILOT ROD	開關引導棒	1
	AA30007-2	Cord 1FT with EUROPE Plug	1呎長電源線 歐規	1	38	GK91211	"C" RING	齒輪固定C環	1
	AA30007-5	Cord 1FT with BRITISH Plug	1呎長電源線 英規	1	39	GI28444-1	IRON WASHER	齒輪固定片	1
	AA30007-5E	Cord 1FT with INDIA Plug	1呎長電源線 印規	1	40	G21301	WASHER	齒輪墊圈	1
	AA30007-1D	Cord 1FT with AUSTRALIA Plug	1呎長電源線 澳規	1	41	GH21221-1	IDLE GEAR	游星齒輪	3
3	EJ30002-5	EMC-BOX ASSEMBLY	EMC盒成品	1	42	GG21231-1	GEAR SEAT	下齒盤	1
4	EC30006	EMC-BOX	EMC盒	1	43	GA91281	GEAR CASE	上離合器筒	1
5	EG30005	P.C.B	PC板	1	44	GN21251	MAIN BEARING	離合器主軸承	2
6	CH90152-1F	SCREW	螺絲	2	45	GW21531	IRON RING	鐵墊圈	1
7	ED30004	FILTER	電磁夾	1	46	GC31321A	CAM	上離合器頭	1
8	AA30009-1T	CORD 9"	9呎長電源線	1	47	GU30370	STOP PILOT FOR "LA"	停止用酒杯(LA)	1
9	CB91107	HOUSING-UNDERSIDE (ORANGE-BL)	下蓋(橙-黑)	1		GU30371	STOP PILOT FOR "LB"	停止用酒杯(LB)	1
10	CA92107	HOUSING-UPSIDE FOR (ORANGE-BL)	上蓋(橙-黑)	1	48	GP30351	STEEL BALLS	跳脫鋼珠	3
11	CC70012	TRIGGER	手按開關桿	1	49	GP30351	STELL BALLS 4mm	酒杯鋼珠(4mm)	2
12	CJ20011	SUSPENSION RING	起子吊環	1	50	GD31351A-1	BIT HOLDER FOR "A"TYPE	傳動軸(A)	1
13	EG91131-3	CONTROL BOARD FOR "110V"	PC板(110V)	1		GD31353B-1	BIT HOLDER FOR "B"TYPE	傳動軸(B)	1
	EG91132-1	CONTROL BOARD FOR "220V"	PC板(220V)	1	51	GP21291A	BIT PILOT FOR "A"TYPE	起子頭帽鋼珠(A)	2
14	HB91061	SHUT OFF SWITCH	停止開關	1		GP21291B	BIT PILOT FOR "B"TYPE	起子頭帽鋼珠(B)	2
15	E31908	BRAKE RESISTOR FOR 110V	剎車電阻(阻抗)-110V	1	52	GF31371	WARING PLATE FOR "LA"	扭力推盤(LA)	1
	E31908-4	BRAKE RESISTOR FOR 220V	剎車電阻(阻抗)-220V	1		GF31372	WARING PLATE FOR "LB"	扭力推盤(LB)	1
16	CE90101-1	SWITCH BASE	三合一開關架	1	53	GE91381-2	WRING SPRING	扭力彈簧	1
17	HB30061	START SWITCH	啟動開關	1	54	GY31391	WARING SPRING BASE-LA	止推盤-LA	1
18	CH90121	SCREW	螺絲	1		GY21321	WARING SPRING BASE-LB	止推盤-LB	1
19	CH90131	SCREW	螺絲	1	55	GK20231B	C-RING FOR LA TYPE	傳動軸固定 C環 LA	1
20	HA91041	CHANGEVER SWITCH	正反開關	1	56	GB21331-1	CLUTCH CASE	下離合器筒	1
21	CH90151-1	SCREW	螺絲	2	57	GO21341	BIT SPRING	起子頭帽彈簧	1
22	CH20102	SCREW	螺絲	3	58	GJ21351	BIT SLEEVE	起子頭帽	1
23	MO91111PF	MOTOR ASSEMBLY FOR "110V"	馬達整組(110V)	1	59	GQ21361	"C" RING	起子頭帽 C環	1
	MO91112PF	MOTOR ASSEMBLY FOR "220V"	馬達整組(220V)	1	60	GL21371	TORQUE ADJUST PING	扭力調整棒	4
24	MI31611	PILOT ROD	開關引導棒	1	61	GM21381	TORQUE ADJUST RING	扭力調整環	1
25	EB33610-2	CERAMICS CAPACITOR	陶瓷電容	2	62	GS21391	"C"RING	扭力環 C環	1
26	MD91531	BRUSH CAP	碳刷蓋	2	63	CD91031-1	COUPLER (BLACK)	前鎖環(黑)	1
27	MC21411	CARBON FOR "110V"	碳刷(110V)	2	64	CH30681T	GROUNDING MEANS	接地線	1
	MC20161	CARBON FOR"220V"	碳刷(220V)	2	65	MF91101	INSULATING	墊圈	1
28	ML91551	MOTOR TOP COVER FOR "110V"	碳刷座(110V)	1	66	CH20102-10	WASHER	墊片	1
	ML91552	MOTOR TOP COVER FOR "220V"	碳刷座(220V)	1	67	CH20102-11	SCREW	螺絲	1
29	ME21481	ARMATURE BEARING	馬達軸承	2	68	CH20102-2	WIRE CLAMP	線夾	1
30	MH91591	ARMATURE FOR "110V"	電樞(110V)	1	69	CH20102-3	SCREW FOR WIRE CLAMP	線夾螺絲	2
	MH91592-5	ARMATURE FOR "220V"	電樞(220V)	1	70	CH20102-7	WIRE CONNECTER	螺式接頭	2
31	MJ91621PF	MOTOR YOKE ASSEMBLY	馬達鐵圈連磁鐵	1	71	P12104	3cm RETAINING CLIP	三分公固定線	1
32	MB91641A	MOTOR END COVER	馬達前蓋	1					

## ✳ Torque Adjustment Operation

1. To adjust the torque on these screwdrivers. Proceed as follows :
2. Determine the torque output of the tool by checking a tightened Fastener with a torque wrench.
3. Increase or decrease the torque by rotating the Spring Adjusting Ring. Rotating the Ring clockwise to a higher number on the torque Scale increase torque output while rotating the Ring counterclockwise to a lower number decreases the torque output.
4. Check the adjustment with a torque wrench. A number of factors will affect torque output from one job to another. Final torque adjustment should be made at the job through a of series of gradual increase. Always start below the desired torque and work upward.
5. Adjust the bit torque by changing the driving in length of the adjust ring at the end.
6. The relationship between torque scale and bit torque is as shown Ring, in the torque diagram. The figures of torque scale do not indicate bit torque values. However, the clamping torque of screw itself is different form type, size, material of the screw and the material of its mating part. Use it as standard to obtain an appropriate clamping torque.
7. The (Return torque method) in which once-clamped screw is returned with torque wrench or the like is available as one of torque control methods however, note that the measured values by the return torque method generally appear in 10%~30% lower than the actually clamping torque.
8. The torque checker measures the torque of screwdriver. The clamping torque of screw itself is different from the clamped conditions. Understand the correlation between clamping torque values and the torque checker values perform the torque control properly.

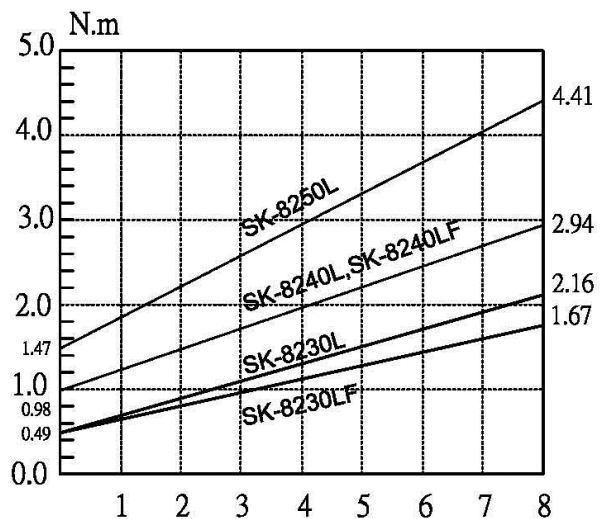
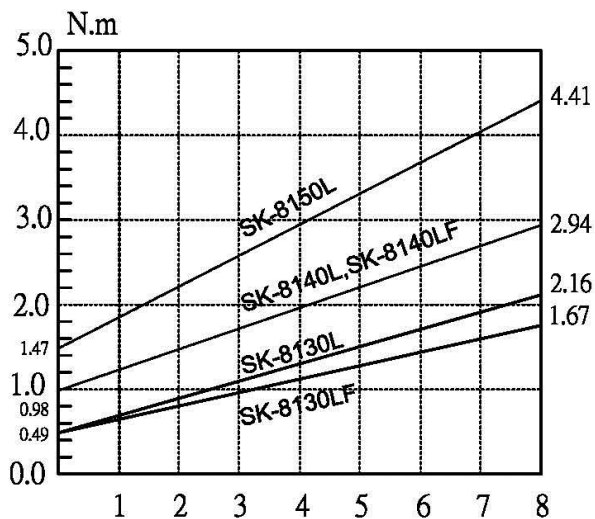

### CAUTION

1. Also in reverse rotation, the clutch is turned off in such manner as in normal rotation, stopping the motor running. Accordingly, when the screw tightened at a large torque, set it to a higher torque scale.
2. The number from zero to eight on the Torque Scale are reference number only and not an indication of actual torque output.

Equipment name: Electric screwdriver						
Type designation (Type): SK-8130L,SK-8140L,SK-8150L,SK-8130LF,SK-8140LF						
Unit	Restricted substances and its chemical symbols					
	Lead (Pb)	Mercury (Hg)	Cadmium (Cd)	Hexavalent chromium (Cr <sup>+6</sup> )	Polybrominated biphenyls (PBB)	Polybrominated diphenyl ethers (PBDE)
Housing	<input type="radio"/>	<input type="radio"/>	<input type="radio"/>	<input type="radio"/>	<input type="radio"/>	<input type="radio"/>
Switch line	<input type="radio"/>	<input type="radio"/>	<input type="radio"/>	<input type="radio"/>	<input type="radio"/>	<input type="radio"/>
MOTOR ASSEMBLY	<input type="radio"/>	<input type="radio"/>	<input type="radio"/>	<input type="radio"/>	<input type="radio"/>	<input type="radio"/>
Gear Housing	<input type="radio"/>	<input type="radio"/>	<input type="radio"/>	<input type="radio"/>	<input type="radio"/>	<input type="radio"/>
CORD ASSEMBLY	<input type="radio"/>	<input type="radio"/>	<input type="radio"/>	<input type="radio"/>	<input type="radio"/>	<input type="radio"/>

RoHS

## Specifications

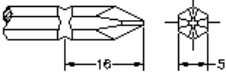
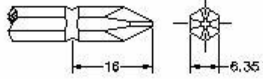
MODEL	SK-8130P	SK-8140P SK-8140PF	SK-8150P	SK-8130PF	SK-8230P	SK-8240P SK-8240PF	SK-8250P	SK-8230PF	
Input voltage(AC)	AC 110~120V 50/60Hz				AC 220~240V 50/60Hz				
Rated input	68W								
Bit torque	(kgf.cm)	5-22	10-30	15-45	5-17	5-22	10-30	15-45	5-17
	(Lbf.in)	4.34-19.12	8.67-26.02	13-39.02	4.34-14.78	4.34-19.12	8.67-26.02	13-39.02	4.34-14.78
	(N.m)	0.49-2.16	0.98-2.94	1.47-4.41	0.49-1.67	0.49-2.16	0.98-2.94	1.47-4.41	0.49-1.67
Torque Accuracy (%)	±3%								
Torque Adjustment	Step less								
Rev speed at no load ( R.p.m)	1000	700 1000	500	1900	1000	700 1000	500	1900	
Non-power Consumption (A)	0.4A				0.3A				
Metal assembly screw	Machine screw(mm)	2.6~4.0	3.0~5.0	4.0~6.0	2.3-3.5	2.6~4.0	3.0~5.0	4.0~6.0	2.3-3.5
	Tapping screw(mm)	2.0~3.5	2.6~4.0	3.0~5.0	2.0~3.0	2.0~3.5	2.6~4.0	3.0~5.0	2.0~3.0
Weight (g)	700								
Length (mm)	269								
Model of Torque Fixing Ring	KC-1								
Model of Suspension Rack	KH-3 · (KC & KH-1)								
Bit Type	 HEX 5mm,				 HEX 6.35mm				

1N.m=10.2Kgf.cm 1N.m=8.85Lbf.in

## Accessories

1. BIT Type :
- No. 00 ... Bit use in dia 1.3~1.8mm screw
  - No. 0 ... Bit use in dia 1.8~2.0mm screw
  - No. 1 ... Bit use in dia 2.0~2.6mm screw
  - No. 2 ... Bit use in dia 3.0~4.0mm screw

SK-8130P ; SK-8230P	with BIT	1# & 2#	1 Pce Each.
SK-8140P ; SK-8240P	with BIT	2#	2 Pcs.
SK-8150P ; SK-8250P	with BIT	2#	2 Pcs
SK-8130PF ; SK-8230PF	with BIT	1# & 2#	1 Pce Each
SK-8140PF ; SK-8240PF	with BIT	2#	2 Pcs

2. Suspension rack and Torque fixing ring acceptable for use with the tool are available from KILEWS catalogue.



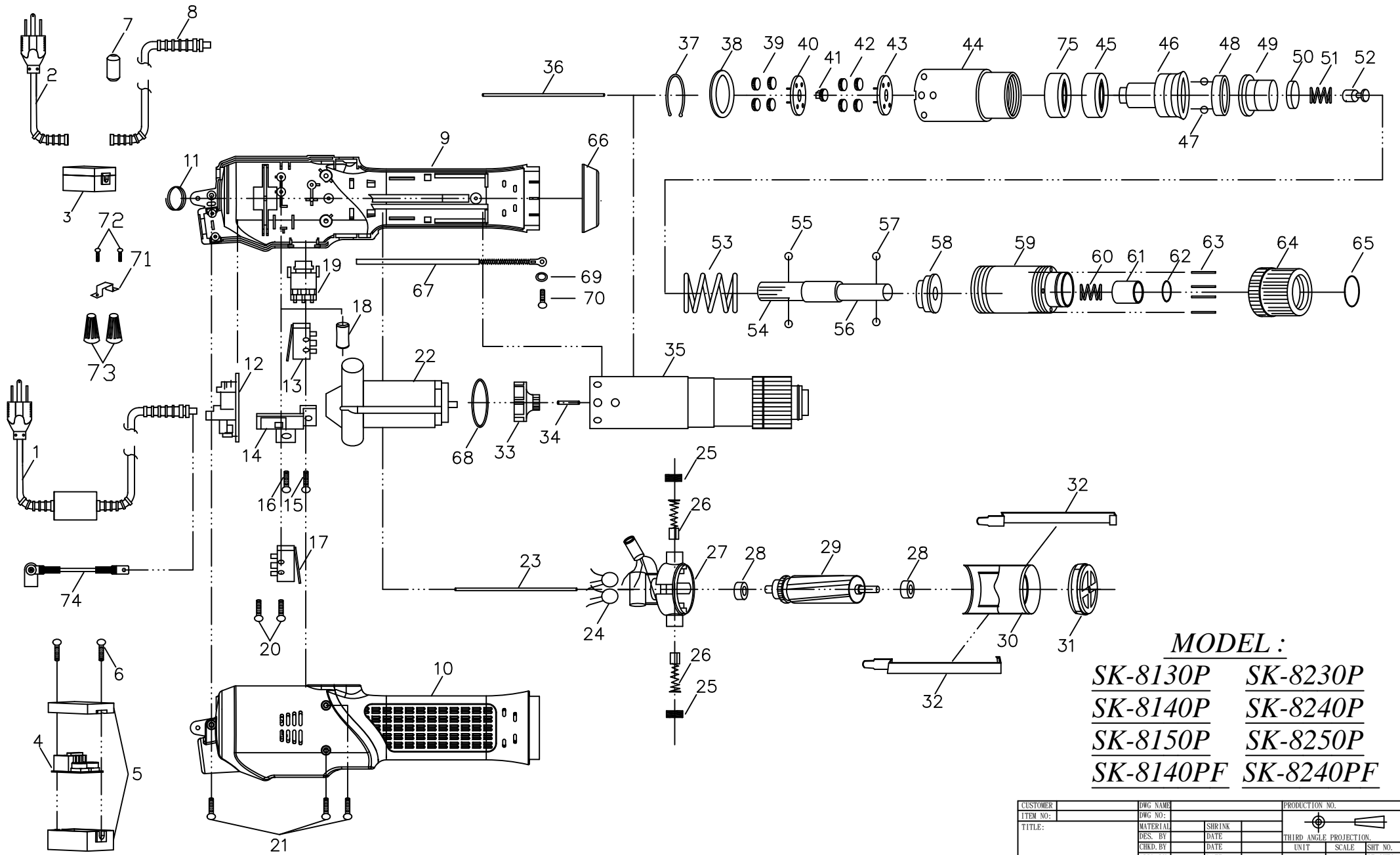

**MODEL :**

- |                  |                  |
|------------------|------------------|
| <u>SK-8130P</u>  | <u>SK-8230P</u>  |
| <u>SK-8140P</u>  | <u>SK-8240P</u>  |
| <u>SK-8150P</u>  | <u>SK-8250P</u>  |
| <u>SK-8140PF</u> | <u>SK-8240PF</u> |

CUSTOMER	DWG NAME	PRODUCTION NO.		
ITEM NO:	DWG NO:	 THIRD ANGLE PROJECTION		
TITLE:	MATERIAL			
	DES. BY		SHRINK	
	CHKD. BY		DATE	
	APPD. BY		DATE	
		UNIT	SCALE	SHT NO.
				OF SHTS.

**KILEWS INDUSTRIAL CO., LTD.**

NO	PARTS NO	PARTS NAME-E	PARTS NAME-C	O'tv	NO	PARTS NO	PARTS NAME-E	PARTS NAME-C	O'tv
1	AC30001-1	Cord Assv-AMERICA Plug	電源線整組 美規	1	1	GZ91072A	CLUTCH ASSEMBLY FOR 8140PA	離合器整組 8140PA	1
	AF30001-1	Cord Assv-EUROPE Plug	電源線整組 歐規	1	1	GZ91072B	CLUTCH ASSEMBLY FOR 8140PB	離合器整組 8140PB	1
	AG30001-1	Cord Assv-BRITISH Plug	電源線整組 英規	1	1	GZ92071A	CLUTCH ASSEMBLY FOR 8150PA	離合器整組 8150PA	1
	AI30001-1	Cord Assv-INDIA Plug	電源線整組 印規	1	1	GZ92071B	CLUTCH ASSEMBLY FOR 8150PB	離合器整組 8150PB	1
	AD30001-1Y	Cord Assv-AUSTRALIA Plug	電源線整組 澳規	1	1	GZ91072AF	CLUTCH ASSEMBLY FOR 8140PFA	離合器整組 8140PFA	1
	AC30001-1F	Cord Assv-AMERICA Plug FOR "8140PF,8240PF"	電源線整組 美規 8140PF,8240PF	1	1	GZ91072BF	CLUTCH ASSEMBLY FOR 8140PFB	離合器整組 8140PFB	1
	AF30001-1F	Cord Assv-EUROPE Plug FOR "8140PF,8240PF"	電源線整組 歐規 8140PF,8240PF	1	36	MI90201	PILOT ROD	開關引導棒	1
	AG30001-1F	Cord Assv-BRITISH Plug FOR "8140PF,8240PF"	電源線整組 英規 8140PF,8240PF	1	37	GK91211	"C" RING	齒輪固定C環	1
	AI30001-1F	Cord Assv-INDIA Plug FOR "8140PF,8240PF"	電源線整組 印規 8140PF,8240PF	1	38	GI28444-1	IRON WASHER 8130P,8140PF	齒輪固定片 8130P,8140PF	1
	AD30001-1YF	Cord Assv-AUSTRALIA Plug FOR "8140PF,8240PF"	電源線整組 澳規 8140PF,8240PF	1	1	GI28444	IRON WASHER 8140P,8150P	齒輪固定片 8140P,8150P	1
2	AA30007-1	Cord 1FT with AMERICA Plug	1呎長電源線 美規	1	39	GH20241	IDLE GEAR FOR 8130P	游星齒輪(8130P)	3
	AA30007-2	Cord 1FT with EUROPE Plug	1呎長電源線 歐規	1	1	GH91232	IDLE GEAR FOR 8140P	游星齒輪(8140P)	3
	AA30007-5	Cord 1FT with BRITISH Plug	1呎長電源線 英規	1	1	GH92231	IDLE GEAR FOR 8150P	游星齒輪(8150P)	4
	AA30007-5E	Cord 1FT with INDIA Plug	1呎長電源線 印規	1	1	GH21221-2	IDLE GEAR FOR 8140PF	游星齒輪(8140PF)	4
	AA30007-1D	Cord 1FT with AUSTRALIA Plug	1呎長電源線 澳規	1	40	GG21231	GEAR SEAT FOR 8130P	上齒盤(8130P)	1
3	EI30002-2	EMC-BOX ASSEMBLY	EMC盒成品	1	1	GG20271	GEAR SEAT FOR 8140PF	上齒盤(8140PF)	1
	EI30002-5	EMC-BOX ASSEMBLY FOR "8140LF,8240LF"	EMC盒成品 8140LF,8240LF	1	1	GG91242-1	GEAR SEAT FOR 8140P	上齒盤含中心齒(8140P)	1
4	EG30005-3	P.C.B	PC板	1	1	GG92241-1	GEAR SEAT FOR 8150P	上齒盤含中心齒(8150P)	1
	EG30005	P.C.B FOR "8140LF,8240LF"	PC板 8140LF,8240LF	1	41	G20102	GEAR SUN ONLY FOR 8130P	中心齒(8130P)	1
5	EC30006	EMC-BOX CASE ONLY	EMC盒	1	1	G20104	GEAR SUN ONLY FOR 8140PF	中心齒(8140PF)	1
6	CH90152-1F	SCREW	螺絲	2	42	GH20241	IDLE GEAR FOR 8130P	游星齒輪(8130P)	3
7	FD30004	FILTER	雷磁夾	1	1	GH91232-1	IDLE GEAR FOR 8140P	游星齒輪(8140P)	3
8	AA30009-1T	CORD 9"	9呎長電源線	1	1	GH92231-1	IDLE GEAR FOR 8150P	游星齒輪(8150P)	4
9	CB91026	HOUSING-UNDERSIDE (ORANGE-BL.)	下蓋(橙-黑)	1	1	GH21221-2	IDLE GEAR FOR 8140PF	游星齒輪(8140PF)	4
10	CA91186	HOUSING-UPSIDE FOR (ORANGE-BL.)	上蓋(橙-黑)	1	43	GG21231	GEAR SEAT FOR 8130P	下齒盤(8130P)	1
11	CI20011	SUSPENSION RING	起子吊環	1	1	GG91272-1	GEAR SEAT FOR 8140P	下齒盤(8140P)	1
12	EG91132	CONTROL BOARD FOR "220V"	PC板(220V)	1	1	GG92271-1	GEAR SEAT FOR 8150P	下齒盤(8150P)	1
	EG91131	CONTROL BOARD FOR "110V"	PC板(110V)	1	1	GG20271	GEAR SEAT FOR 8140PF	下齒盤(8140PF)	1
13	HB91061	START SWITCH	啟動開關	1	44	GA91281	GEAR CASE FOR 8130P	上離合器筒(8130P)	1
14	CH90101-1	SWITCH BASE	三合一開關架	1	1	GA91282	GEAR CASE FOR 8140P,8150P	上離合器筒(8140P,8150P)	1
15	CH90121	SCREW	螺絲	1	1	GA91282-1	GEAR CASE FOR 8140PF	上離合器筒(8140PF)	1
16	CH90131	SCREW	螺絲	1	45	GN21251	MAIN BEARING	離合器主軸承	1
17	HB30061	SHUT OFF SWITCH	停止開關	1	46	GX90303-1	CAM	上離合器頭	1
18	F31908	BRAKE RESISTOR FOR 110V	剎車電阻(阻抗)-110V	1	47	GP30351	STEEL BALLS	鋼珠	3
	F31908-4	BRAKE RESISTOR FOR 220V	剎車電阻(阻抗)-220V	1	48	GW21532	IRON RING	鐵墊圈	1
19	HA91041	CHANGE OVER SWITCH FOR "8130P"	正反開關(8130P)	1	49	GF90321-1	WARNING PLATE	扭力推盤	1
	HA91042	CHANGE OVER SWITCH FOR "8140P,PF"	正反開關(8140P,PF)	1	50	GV90331	INNER SPRING CAP	內彈簧蓋	1
	HA92051	CHANGE OVER SWITCH FOR "8150P"	正反開關(8150P)	1	51	GO90341	INNER SPRING	下壓式內彈簧	1
20	CH90151-1	SCREW	螺絲	2	52	GI30370	STOP PILOT	停止用酒杯	1
21	CH20102	SCREW	螺絲	3	53	GE91381	WRING SPRING FOR 8130P	扭力彈簧(8130P)	1
22	MO91111	MOTOR ASSEMBLY FOR "110V"	馬達整組(110V)	1	1	GE91382	WRING SPRING FOR 8140P,PF	扭力彈簧(8140P,PF)	1
	MO91111-2	MOTOR ASSEMBLY FOR "8140PF"	馬達整組(8140PF)	1	1	GE92382-2	WRING SPRING FOR 8150P	扭力彈簧(8150P)	1
	MO91112	MOTOR ASSEMBLY FOR "220V"	馬達整組(220V)	1	54	GD91402-1	SHAFT	六角軸	1
	MO91112-2	MOTOR ASSEMBLY FOR "8240PF"	馬達整組(8240PF)	1	55	GP30351	STEEL BALLS 4mm	酒杯鋼珠(4mm)	2
23	MI90481	PILOT ROD	開關引導棒	1	56	GT91401A-1	BIT HOLDER FOR "A" TYPE	起子頭(A)	1
24	EB33610-2	CERAMICS CAPACITOR	陶瓷電容	2	1	GT91401C-1	BIT HOLDER FOR "B" TYPE	起子頭(B)	1
25	MD91531	BRUSH CAP	碳刷蓋	2	57	GP21291A	BIT PILOT FOR "A" TYPE	起子頭帽鋼珠(A)	2
26	MC21411	CARBON FOR "110V"	碳刷(110V)	2	1	GP21291B	BIT PILOT FOR "B" TYPE	起子頭帽鋼珠(B)	2
	MC20161	CARBON FOR "220V"	碳刷(220V)	2	58	GY21321	WRING SPRING BASE	止推盤	1
27	MI91551	MOTOR TOP COVER FOR "110V"	碳刷座(110V)	1	59	GB21331-1	CLUTCH CASE	下離合器筒	1
	MI91552	MOTOR TOP COVER FOR "220V"	碳刷座(220V)	1	60	GO21341	BIT SPRING	起子頭帽彈簧	1
28	ME21481	ARMATURE BEARING	馬達軸承	2	61	GI21351	BIT SLERVE	起子頭帽	1
29	MH91591	ARMATURE FOR "110V"	電樞(110V)	1	62	GO21361	"C" RING	起子頭帽C環	1
	MH91591PF	ARMATURE FOR "8140PF"	電樞(8140PF)	1	63	GI21371	TORQUE ADJUST PING	扭力調整棒	4
	MH91592	ARMATURE FOR "220V"	電樞(220V)	1	64	GM21381	TORQUE ADJUST RING	扭力調整環	1
	MH91592-1	ARMATURE FOR "8240PF"	電樞(8240PF)	1	65	GS21391	"C" RING	扭力環C環	1
30	MI91621	MOTOR YOKE ASSEMBLY	馬達鐵圈連磁鐵	1	66	CD91031-1	COUPLER (BLACK)	前鎖環(黑)	1
	MI91621PF	MOTOR YOKE ASSEMBLY FOR 8140PF 8240PF	馬達鐵圈連磁鐵 8140PF 8240PF	1	67	CH30681T	GROUNDING MEANS	接地線	1
31	MB91641A	MOTOR END COVER	馬達前蓋	1	68	MF91101	INSULATING	墊圈	1
32	MA91611B	ASSEMBLING SPRING FOR "8130P"	馬達固定鐵片	2	69	CH20102-10	WASHER	墊片	1
33	MK21111	FAN FOR "8130P,8230P"	風扇(8130P,8230P)	1	70	CH20102-11	SCREW	螺絲	1
	MK91091	FAN FOR "8140P,8240P"	風扇(8140P,8240P)	1	71	CH20102-2	WIRE CLAMP	線夾	1
	MK92091	FAN FOR "8150P,8250P"	風扇(8150P,8250P)	1	72	CH20102-3	SCREW FOR WIRE CLAMP	線夾螺絲	2
	MK21112	FAN FOR "8140PF,8240PF"	風扇(8140PF,8240PF)	1	73	CH20102-7	WIRE CONNECTER	螺式接頭	2
34	MG91081	PILOT ROD	開關棒	1	74	PI2104	3cm RETAINING CLIP	三分固定線	1
35	GZ91071A	CLUTCH ASSEMBLY FOR 8130PA	離合器整組 8130PA	1	75	GN21251	MAIN BEARING	離合器主軸承	1
	GZ91071B	CLUTCH ASSEMBLY FOR 8130PB	離合器整組 8130PB	1	1				1

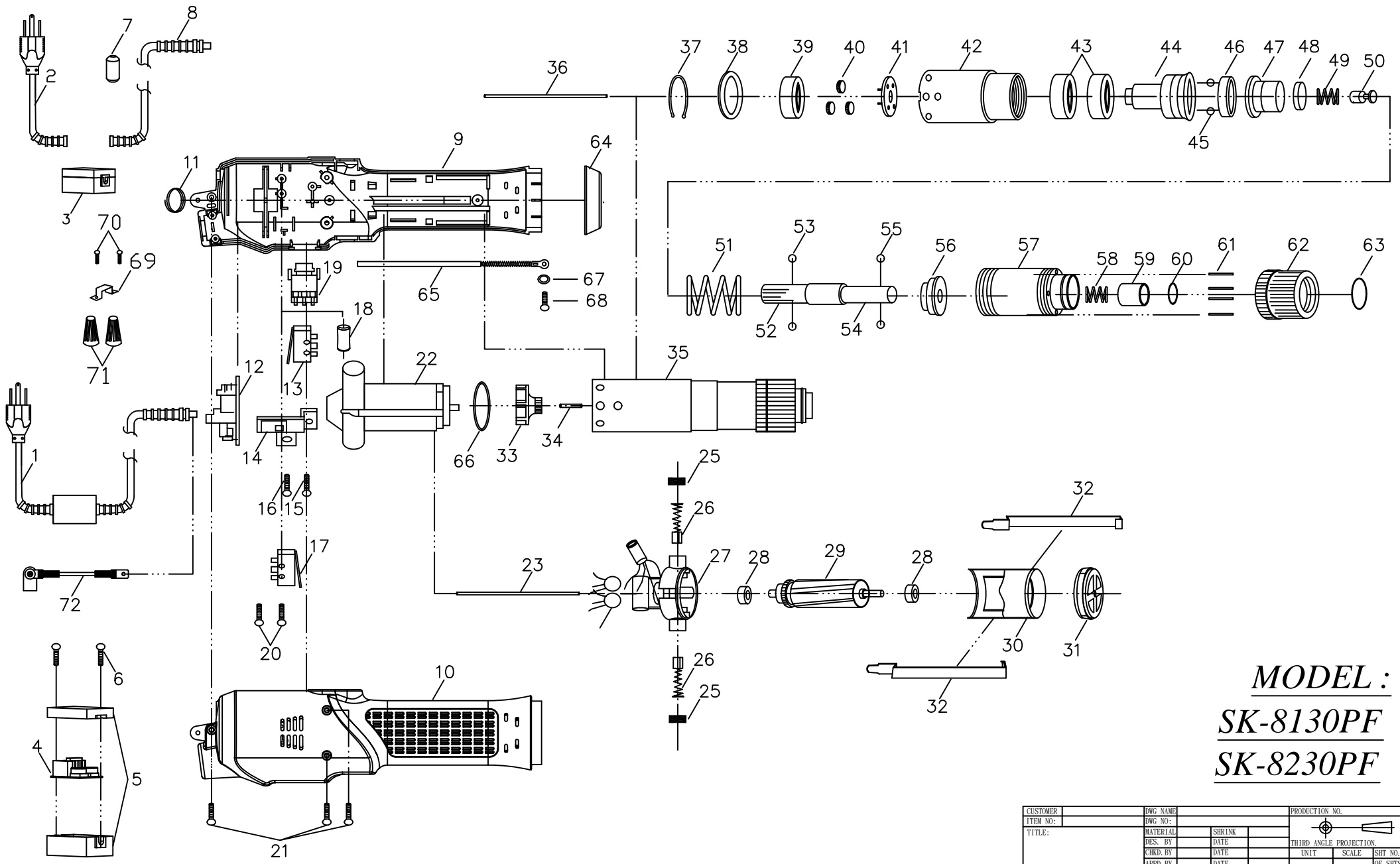

**MODEL :**  
**SK-8130PF**  
**SK-8230PF**

CUSTOMER	DWG NAME	PRODUCTION NO.		
ITEM NO:	DWG NO:			
TITLE:	MATERIAL	SHRINK	THIRD ANGLE PROJECTION.	
	DES. BY	DATE	UNIT	SCALE
	CHKD. BY	DATE		SHIT NO.
	APPD. BY	DATE		OF SHITS.
<b>KILEWS INDUSTRIAL CO., LTD.</b>				

NO	PARTS NO	PARTS NAME-E	PARTS NAME-C	Q'ty	NO	PARTS NO	PARTS NAME-E	PARTS NAME-C	Q'ty
1	AC30001-1F	Cord Assy-AMERICA Plug	電源線整組 美規	1	32	MA91611B	ASSEMBLING SPRING	馬達固定鐵片	2
	AF30001-1F	Cord Assy-EUROPE Plug	電源線整組 歐規	1	33	MK21111PF	FAN	風扇	1
	AG30001-1F	Cord Assy-BRITISH Plug	電源線整組 英規	1	34	MG30081-1	PILOT ROD	陶瓷棒	1
	AJ30001-1F	Cord Assy-INDIA Plug	電源線整組 印規	1	35	GZ91071AF	CLUTCH ASSEMBLY FOR 8130PFA	離合器整組 8130PFA	1
	AD30001-1YF	Cord Assy-AUSTRALIA Plug	電源線整組 澳規	1		GZ91071BF	CLUTCH ASSEMBLY FOR 8130PFB	離合器整組 8130PFB	1
2	AA30007-1	Cord 1FT with AMERICA Plug	1呎長電源線 美規	1	36	MI90201	PILOT ROD	開關引導棒	1
	AA30007-2	Cord 1FT with EUROPE Plug	1呎長電源線 歐規	1	37	GK91211	"C" RING	齒輪固定C環	1
	AA30007-5	Cord 1FT with BRITISH Plug	1呎長電源線 英規	1	38	GI28444-1	IRON WASHER	齒輪固定片	1
	AA30007-5E	Cord 1FT with INDIA Plug	1呎長電源線 印規	1	39	G21301	WASHER	齒輪墊圈	1
	AA30007-1D	Cord 1FT with AUSTRALIA Plug	1呎長電源線 澳規	1	40	GH20241	IDLE GEAR	游星齒輪	6
3	EJ30002-5	EMC-BOX ASSEMBLY	EMC盒成品	1	41	GG21231-1	GEAR SEAT	下齒盤	1
4	EG30005	P.C.B	PC板	1	42	GA91281	GEAR CASE	上離合器筒	1
5	EC30006	EMC-BOX CASE ONLY	EMC盒	1	43	GN21251	MAIN BEARING	離合器主軸承	2
6	CH90152-1F	SCREW	螺絲	2	44	GX90303-1	CAM	上離合器頭	1
7	ED30004	FILTER	電磁夾	1	45	GP30351	STEEL BALLS	跳脫鋼珠	3
8	AA30009-1T	CORD 9"	9呎長電源線	1	46	GW21532	IRON RING	鐵墊圈	1
9	CB91026	HOUSING-UNDERSIDE (ORANGE-BL)	下蓋(橙-黑)	1	47	GF90321-1	WARING PLATE	扭力推盤	1
10	CA91186	HOUSING-UPSIDE FOR (ORANGE-BL)	上蓋(橙-黑)	1	48	GV90331	INNER SPRING CAP	內彈簧蓋	1
11	CI20011	SUSPENSION RING	起子吊環	1	49	GO90341	INNER SPRING	下壓式內彈簧	1
12	EG91131	CONTROL BOARD FOR "110V"	PC板(110V)	1	50	GU30370	STOP PILOT	停止用酒杯	1
	EG91132	CONTROL BOARD FOR "220V"	PC板(220V)	1	51	GE90361-3	WRING SPRING	扭力彈簧	1
13	HB91061	START SWITCH	啟動開關	1	52	GD91402-1	SHAFT	六角軸	1
14	CE90101-1	SWITCH BASE	三合一開關架	1	53	GP30351	STELL BALLS 4mm	酒杯鋼珠(4mm)	2
15	CH90121	SCREW	螺絲	1	54	GT91401A-1	BIT HOLDER FOR "A"TYPE	起子頭(A)	1
16	CH90131	SCREW	螺絲	1		GT91401C-1	BIT HOLDER FOR "B"TYPE	起子頭(B)	1
17	HB30061	SHUT OFF SWITCH	停止開關	1	55	GP21291A	BIT PILOT FOR "A"TYPE	起子頭帽鋼珠(A)	2
18	E31908	BRAKE RESISTOR FOR 110V	剎車電阻(阻抗)-110V	1		GP21291B	BIT PILOT FOR "B"TYPE	起子頭帽鋼珠(B)	2
	E31908-4	BRAKE RESISTOR FOR 220V	剎車電阻(阻抗)-220V	1	56	GY21321	WRING SPRING BASE	止推盤	1
19	HA91041	CHANGEVER SWITCH	正反開關	1	57	GB21331-1	CLUTCH CASE	下離合器筒	1
20	CH90151-1	SCREW	螺絲	2	58	GO21341	BIT SPRING	起子頭帽彈簧	1
21	CH20102	SCREW	螺絲	3	59	GJ21351	BIT SLEEVE	起子頭帽	1
22	MO91111PF	MOTOR ASSEMBLY FOR "110V"	馬達整組(110V)	1	60	GQ21361	"C" RING	起子頭帽C環	1
	MO91112PF	MOTOR ASSEMBLY FOR "220V"	馬達整組(220V)	1	61	GL21371	TORQUE ADJUST PING	扭力調整棒	4
23	MI90481	PILOT ROD	開關引導棒	1	62	GM21381	TORQUE ADJUST RING	扭力調整環	1
24	EB33610-2	CERAMICS CAPACITOR	陶瓷電容	2	63	GS21391	"C"RING	扭力環C環	1
25	MD91531	BRUSH CAP	碳刷蓋	2	64	CD91031-1	COUPLER (BLACK)	前鎖環(黑)	1
26	MC21411	CARBON FOR "110V"	碳刷(110V)	2	65	CH30681T	GROUNDING MEANS	接地線	1
	MC20161	CARBON FOR"220V"	碳刷(220V)	2	66	MF91101	INSULATING	墊圈	1
27	ML91551	MOTOR TOP COVER FOR "110V"	碳刷座(110V)	1	67	CH20102-10	WASHER	墊片	1
	ML91552	MOTOR TOP COVER FOR "220V"	碳刷座(220V)	1	68	CH20102-11	SCREW	螺絲	1
28	ME21481	ARMATURE BEARING	馬達軸承	2	69	CH20102-2	WIRE CLAMP	線夾	1
29	MH91591	ARMATURE FOR "110V"	電樞(110V)	1	70	CH20102-3	SCREW FOR WIRE CLAMP	線夾螺絲	2
	MH91592-5	ARMATURE FOR "220V"	電樞(220V)	1	71	CH20102-7	WIRE CONNECTER	螺式接頭	2
30	MJ91621PF	MOTOR YOKE ASSEMBLY	馬達鐵圈連磁鐵	1	72	P12104	3cm RETAINING CLIP	三分公固定線	1
31	MB91641A	MOTOR END COVER	馬達前蓋	1					

## Torque Adjustment Operation

To adjust the torque on these screwdrivers. Proceed as follows :

1. Determine the torque output of the tool by checking a tightened Fastener with a torque wrench.
2. Increase or decrease the torque by rotating the Spring Adjusting Ring. Rotating the Ring clockwise to a higher number on the torque Scale increase torque output while rotating the Ring counterclockwise to a lower number decreases the torque output.
3. Check the adjustment with a torque wrench. A number of factors will affect torque output from one job to another. Final torque adjustment should be made at the job through a of series of gradual increase. Always start below the desired torque and work upward.
4. Adjust the bit torque by changing the driving in length of the adjust ring at the end.
5. The relationship between torque scale and bit torque is as shown Ring, in the torque diagram. The figures of torque scale do not indicate bit torque values. However, the clamping torque of screw itself is different form type, size, material of the screw and the material of its mating part. Use it as standard to obtain an appropriate clamping torque.
6. The (Return torque method) in which once-clamped screw is returned with torque wrench or the like is available as one of torque control methods however, note that the measured values by the return torque method generally appear in 10%~30% lower than the actually clamping torque.
7. The torque checker measures the torque of screwdriver. The clamping torque of screw itself is different from the clamped conditions. Understand the correlation between clamping torque values and the torque checker values perform the torque control properly.

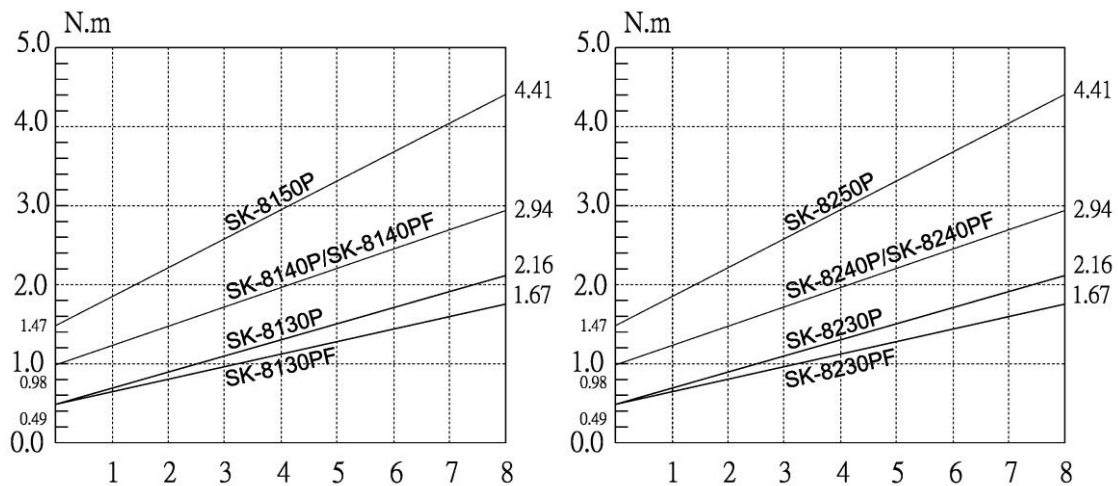

### CAUTION

1. Also in reverse rotation, the clutch is turned off in such manner as in normal rotation, stopping the motor running. Accordingly, when the screw tightened at a large torque, set it to a higher torque scale.
2. The number from zero to eight on the Torque Scale are reference number only and not an indication of actual torque output.

Equipment name: Electric screwdriver						
Type designation (Type): SK-8130P,SK-8140P,SK-8150P,SK-8130PF,SK-8140PF						
Unit	Restricted substances and its chemical symbols					
	Lead (Pb)	Mercury (Hg)	Cadmium (Cd)	Hexavalent chromium (Cr <sup>+6</sup> )	Polybrominated biphenyls (PBB)	Polybrominated diphenyl ethers (PBDE)
Housing	<input type="radio"/>	<input type="radio"/>	<input type="radio"/>	<input type="radio"/>	<input type="radio"/>	<input type="radio"/>
Switch line	<input type="radio"/>	<input type="radio"/>	<input type="radio"/>	<input type="radio"/>	<input type="radio"/>	<input type="radio"/>
MOTOR ASSEMBLY	<input type="radio"/>	<input type="radio"/>	<input type="radio"/>	<input type="radio"/>	<input type="radio"/>	<input type="radio"/>
Gear Housing	<input type="radio"/>	<input type="radio"/>	<input type="radio"/>	<input type="radio"/>	<input type="radio"/>	<input type="radio"/>
CORD ASSEMBLY	<input type="radio"/>	<input type="radio"/>	<input type="radio"/>	<input type="radio"/>	<input type="radio"/>	<input type="radio"/>

RoHS