

**INSULATED TERMINALS (RV)**

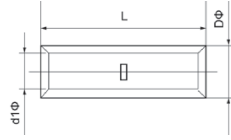

**Material:** Copper tube (Cu) 99% up  
**Surface:** Tin plated  
**Range size (mm):** 1.5-1000



**Insulation:** Vinyl  
**Plating:** Tin  
**Material:** Copper or brass  
**Range size (mm<sup>2</sup>):** 0.5 - 6

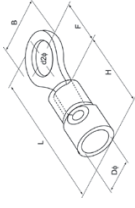

No.	Items	Dimension (mm)			Weight (g)
		d2	d1	D	
1	SL1.5	2.2	0.8	1.1	
2	SL2.5	2.4	0.8	1.17	
3	SL4.4	2.8	0.9	1.71	
4	SL6	3.8	0.9	2.62	
5	SL10	4.5	0.9	3.14	
6	SL16	5.4	0.9	4.25	
7	SL25	6.8	1	6.25	
8	SL35	8.2	1.2	10.91	
9	SL50	9.5	1.5	15.36	
10	SL70	11.2	1.8	28.19	
11	SL95	13.5	2	39.14	
12	SL120	15	2.2	54.39	
13	SL150	16.5	2.4	72.25	
14	SL185	18.5	2.5	94.34	
15	SL240	21	2.8	135.42	
16	SL300	23.5	3.3	216.3	
17	SL400	28.5	4	377.36	
18	SL500	30	4.5	450.7	
19	SL630	34.5	4.8	618.5	
20	SL800	40	5.6	988.35	
21	SL1000	44	6.3	1,401.70	

Items	Din (mm2)	Dimension (mm)						
		d2	B	L	F	H	D	
RV125-3	0.5-1.5	32	5.7	17.8	5.0	10.0	4.3	
RV125-4	0.5-1.5	4-3	6.6	20.1	6.3	10.0	4.3	
RV125-5	0.5-1.5	5-3	8.0	21.5	7.0	10.0	4.3	
RV125-6	0.5-1.5	6-4	9.8	23	8.5	10.0	4.3	
RV125-8	0.5-1.5	8-4	11.6	27.5	11.1	10.0	4.3	
RV125-10	0.5-1.5	10-5	13.6	31.6	13.9	10.0	4.3	
RV125-12	0.5-1.5	13-0	19.2	36.0	16.5	10.0	4.3	
RV2-3	1.5-2.5	32	6.6	17.8	4.3	10.0	4.9	
RV2-4	1.5-2.5	4-3	6.6	21	7.0	10.0	4.9	
RV2-5	1.5-2.5	5-3	8.5	22.5	7.8	10.0	4.9	
RV2-6	1.5-2.5	6-4	12	27.6	11.0	10.0	4.9	
RV2-8	1.5-2.5	8-4	12	27.6	11.0	10.0	4.9	
RV2-10	1.5-2.5	10-5	13.6	30.2	13.9	10.0	4.9	
RV2-12	1.5-2.5	13-0	19.2	36.5	16.5	10.0	4.9	
RV3.5-4	2.5-4	4-3	8.0	24.5	7.7	13.0	6.2	
RV3.5-5	2.5-4	5-3	8.0	24.5	7.7	13.0	6.2	
RV3.5-6	2.5-4	6-4	12.0	27.9	7.7	13.0	6.2	
RV5.5-5	4-6	5-3	9.5	25.5	8.3	13.0	6.7	
RV5.5-6	4-6	6-4	12.0	31.5	13.0	13.0	6.7	
RV5.5-8	4-6	8-4	15.0	33.7	13.7	13.0	6.7	
RV5.5-10	4-6	10-5	15.0	33.7	13.7	13.0	6.7	
RV5.5-12	4-6	13	19.2	38.1	16.0	13.0	6.7	