

Main accessories with screw terminals

MS132-(K)B, MS165-B, MO132-B, MO165-B



HKF1-11



HK1-11



SK1-11



CK1-11

1S8C101209F0014

1S8C101201F0014

1S8C101286F0014

Manual motor starters can be equipped with auxiliary contacts for lateral/front mounting, signaling contacts for lateral mounting, undervoltage releases and shunt trips. Two different signaling contacts are available. The accessories can be fitted wiring free and without tools. A variety of combinations is possible as required for the application. The auxiliary contacts change position with the main contacts. The signaling contact SK signals tripping regardless if it was caused by short-circuit or overload. The signaling contact CK signals tripping in case it was caused by short-circuit.

Undervoltage releases are used for remote tripping of the manual motor starters especially for emergency stop circuits. Shunt trips release the MMS used for remote tripping. These main accessories are suitable throughout the MS132-(K)B/MS165-B/MO132-B/MO165-B ranges.

Suitable for	Auxiliary contacts N.O.	Auxiliary contacts N.C.	Description	Type	Order code	Pkg qty	Weight (1 pce)
						pce	kg

Auxiliary contacts – mountable on the front

MS132-(K)B,	1	1		HKF1-11	1SAM201901R1001	10	0.015
MS165-B,	1	0		HKF1-10	1SAM201901R1003	10	0.013
MO132-B,	0	1		HKF1-01	1SAM201901R1004	10	0.013
MO165-B	2	0		HKF1-20	1SAM201901R1002	10	0.015

Auxiliary contacts – mountable on the right

MS132-(K)B,	1	1	max. 2 pieces	HK1-11	1SAM201902R1001	2	0.035
MS165-B,	2	0	max. 2 pieces	HK1-20	1SAM201902R1002	2	0.035
MO132-B,	0	2	max. 2 pieces	HK1-02	1SAM201902R1003	2	0.035
MO165-B	2	0	with lead contacts	HK1-20L	1SAM201902R1004	2	0.035

Signaling contacts – mountable on the right

MS132-(K)B,	1	1	for tripped alarm, max. 2 pieces	SK1-11	1SAM201903R1001	2	0.035
MS165-B,	2	0	for tripped alarm, max. 2 pieces	SK1-20	1SAM201903R1002	2	0.035
MO132-B,	0	2	for tripped alarm, max. 2 pieces	SK1-02	1SAM201903R1003	2	0.035
MO165-B							
MS132-(K)B,	1	1	for short-circuit alarm, max. 2 pieces	CK1-11	1SAM301901R1001	2	0.035
MS165-B	2	0	for short-circuit alarm, max. 2 pieces	CK1-20	1SAM301901R1002	2	0.035
	0	2	for short-circuit alarm, max. 2 pieces	CK1-02	1SAM301901R1003	2	0.035

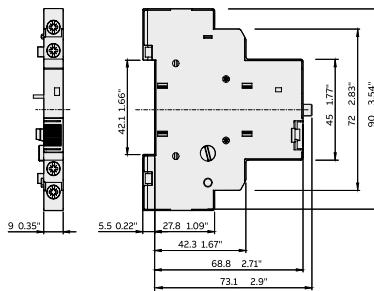

SK1

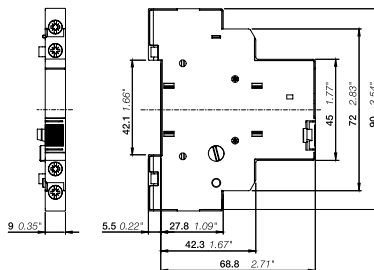

HK1

Main dimensions mm, inches

2CDC24001F0012