

## NON INSULATED TERMINALS (SNB)

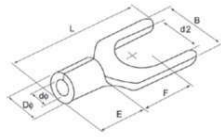

**Insulation:** Copper or Brass  
**Plating:** Tin  
**Material:** Copper or brass  
**Range size (mm<sup>2</sup>):** 0.5 - 6

Welding connector with copper material only

Items	Din (mm <sup>2</sup> )	Dimension (mm)						
		d2	B	L	F	E	D	d
SNB1.25-3	0.5-1.5	3.2	5.7	16	7	4.8	3.4	1.7
SNB1.25-4	0.5-1.5	4.3	6.4	14	7	4.8	3.4	1.7
SNB1.25-5	0.5-1.5	5.3	8.1	16	7	4.8	3.4	1.7
SNB1.25-6	0.5-1.5	6.4	9.5	18	7	4.8	3.4	1.7
SNB1.25-8	0.5-1.5	-	-	-	-	4.8	3.4	1.7
SNB1.25-10	0.5-1.5	-	-	-	-	4.8	3.4	1.7
SNB1.25-12	0.5-1.5	-	-	-	-	4.8	3.4	1.7
SNB2-3	1.5-2.5	3.2	5.7	12.4	7	4.8	4.1	2.3
SNB2-4	1.5-2.5	4.3	6.4	14.6	7	4.8	4.1	2.3
SNB2-5	1.5-2.5	5.3	8.1	16.4	7	4.8	4.1	2.3
SNB2-6	1.5-2.5	6.4	9.5	18.4	7	4.8	4.1	2.3
SNB2-8	1.5-2.5	-	-	-	-	4.8	4.1	2.3
SNB2-10	1.5-2.5	-	-	-	-	4.8	4.1	2.3
SNB3.5-4	2.5-4	4.3	8	18.3	7	6	5	3
SNB3.5-5	2.5-4	5.3	8	18.3	7	6	5	3
SNB3.5-6	2.5-4	6.4	12	21.5	12.00	6	5	3
SNB5.5-5	4-6	5.3	9	19.5	8	6.8	5.6	3.4
SNB5.5-6	4-6	6.4	9	19.5	8	6.8	5.6	3.4
SNB5.5-8	4-6	8.4	14	25.5	8	6.8	5.6	3.4
SNB5.5-10	4-6	-	-	-	-	6.8	5.6	3.4

## CORD-END TERMINALS (E)

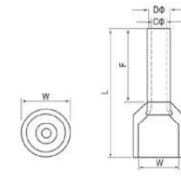

**Insulation:** P,P **Metal:** Copper or Brass

CE RoHS

Wire Range	Item No.	Dimension(mm)					Pcs/ Pack	Insulating tube color	
		F	L	W	DΦ	CΦ		German	French
0.5(22)	E 0508	8.0	14.0	2.6	1.3	1.0	1000	Orange	White
0.75(20)	E 7508	8.0	14.6	2.8	1.5	1.2	1000	White	Blue
1.0(18)	E 1008	8.0	14.6	3.0	1.7	1.4	1000	Yellow	Red
1.5(16)	E 1508	8.0	14.6	3.5	2.0	1.7	1000	Red	Black
2.5(14)	E 2508	8.0	15.2	4.0	2.6	2.5	1000	Blue	Gray
4.0(12)	E 4009	9.0	16.5	4.4	3.2	2.8	1000	Gray	Orange
6.0(10)	E 6012	12.0	20.0	6.3	3.9	3.5	1000	Black	Green
10.0(7)	E 10-12	12.0	21.5	7.6	4.9	4.5	1000	Milk	Brown
16.0(5)	E 16-12	12.0	22.2	8.8	6.2	5.8	500	Green	Milk
	E 25-16	16.0	29.0	11.2	7.9	7.5	250	Brown	
E 25-22	22.0	35.0							
35.0(2)	E 35-16	16.0	30.0	12.7	8.7	8.3	250	Gray	
50.0(1)	E 50-25	25.0	41.0	15.3	10.9	10.3	250	Olive	